



Be Sure  
to Read this  
Manual  
Before Use

# Operation Manual



[www.universal-space.com](http://www.universal-space.com)



# CONTENT

IMPORTANT SAFETY INSTRUCTIONS .....	2
1. SPECIFICATION .....	4
2. PACKAGE CONTENTS .....	5
3. PART NAME .....	6
4. SET UP & INSTALLATION .....	7
5. CONNECTING POWER .....	11
6. HOW TO PLAY.....	12
7. GAME OPTIONS .....	15
8. ERROR MESSAGE AND RECOVERY.....	17
9. MAINTENACE AND DIRECTIONS .....	21
10. OVERALL CONSTRUCTION .....	25

Non-technical personnel who do not have technical knowledge and Expertise should refrain from performing such work that this manual require or perform tasks which are not explained in this manual. Failing to comply can cause severe accidents such as electric shock or other serious injuries. All repairs must be performed to original manufacturer specifications.

**WARNING: To reduce the risk of fire, electric shock or personal injury, unplug or disconnect the machine from the power supply before servicing.**



Thank you for purchasing **AFTER DARK DLX** from Universal Space. We hope you enjoy the product.

This manual contains valuable information about how to operate and maintain your game machine properly and safely. It is intended for the owner and/or personnel in charge of product operation. Carefully read and understand the instructions.

If you need any help during installation and setup please utilize this manual and troubleshooting guide. If the product fails to function properly, *non-technical personnel should under no circumstance attempt to service the machine*. Contact your distributor or manufacturer for help.

Before use, please read **IMPORTANT SAFETY INSTRUCTIONS**.

## **IMPORTANT SAFETY INSTRUCTIONS**

**To ensure the safe usage of this product, carefully read and understand these instructions before operating your game.**

**Save these instructions for future reference.**

Use this product only as described in this manual. Other uses not recommended may cause fire, electric shock or personal injury. Unplug the game from the outlet when not in use, when moving from one location to another, and before cleaning/servicing.

Explanations which require special attention are indicated by signs of warning. Depending on the potential hazardous degree, the terms: **NOTE**, **NOTICE**, and **WARNING** are used.

**NOTE:** A NOTE indicates useful hints or information about product usage.

**NOTICE:** A NOTICE indicates potential damage to product and how to avoid the problem.

**WARNING:** A WARNING indicates a potential for product damage or serious personal Injury.

It is important to understand the meaning of the following **HAZARD SIGNS** before continuing:

### **High Voltage and Shock Hazard:**

High voltage can cause electric shock.

Turn off/unplug power before servicing.



### **High Temperature Hazard:**

This part may cause scalding.

Do not touch. Surface may be hot.



### **No Touching Hazard:**

This part may be hot or can cause electric shock.

Do not touch.





Use the following safety guidelines to help ensure your own personal safety and to help protect your equipment and surrounding environment from potential damage.

**⚠ This product is an indoor game machine. Do not install outdoors.**

Avoid installing in the following places to prevent fire, electric shock, injury and/or machine malfunctioning:

- Places subject to rain/moisture, or places subject to high humidity.
- Places subject to direct sunlight, or places subject to extremely hot or cold temperatures to ensure that it is used within the specified operating range.
- Places where inflammable gas may be present or in the vicinity of highly inflammable/volatile chemicals or items that can easily catch fire
- On unstable or sloped surfaces. The machine may topple or cause unforeseen accidents.
- Vicinity of fire exits, fire extinguishers etc that may block/prevent safety measures

**IMPORTANT NOTE:**

**ALL REPAIRS MUST BE DONE TO ORIGINAL MANUFACTURER SPECIFICATIONS.  
FAILURE TO DO SO VOID ALL WARRANTIES AND OPERATOR ASSUMES ALL RISKS.**

Note: The contents of this manual may be updated without notice.



# 1. SPECIFICATION

Rated power supply:	AC220-110V 50/60Hz
Min. Power consumption:	650W
Max. Power consumption:	1450W
Dimensions:	W1820×D2799×H2553 (mm)
Weight:	Approximately 480kg

**!** **NOTICE:** After turning off the game, please wait at least 1 minute before restarting again.

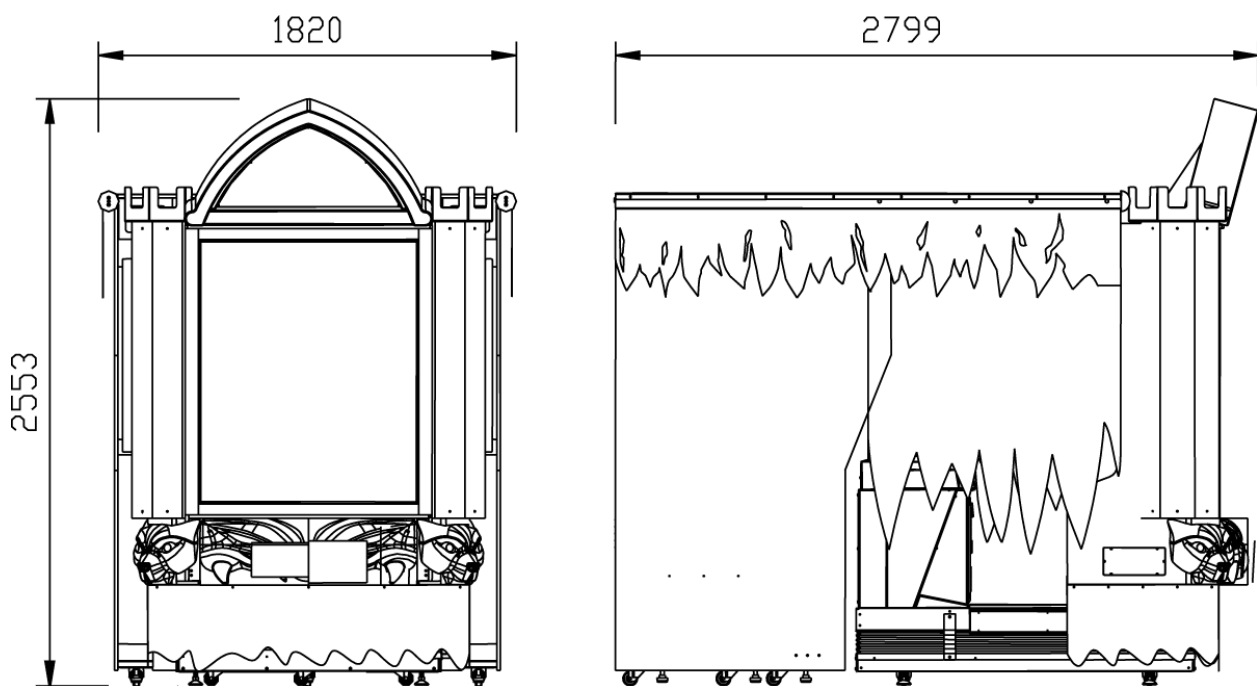

**Note:** Game parameters are subject to change without notice.

**!** **NOTICE:** After turning off the game, please wait at least 1 minute before restarting again.



## 2. PACKAGE CONTENTS

Open the package and make sure all the items are included:

- 1 x Body Assembly

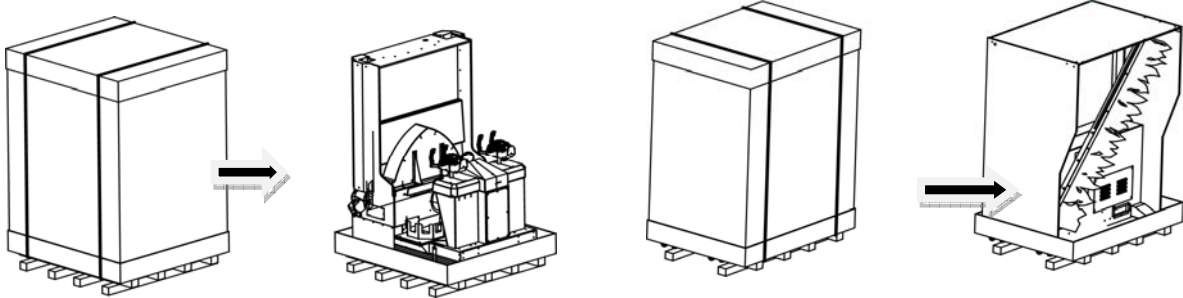

- Following accessories

No.	Part No.	Name	Code No.	Spec.	Illustration	Qty
1	A105-800-000	Power cord	23301050001	10A / 1.8m		1
2	A105-801-000	Fuse	21901000012	5A/Φ5X20mm		1
3	A105-802-000		21901000030	10A/Φ5X20mm		
4	A105-803-000	Manual	41441216A	中文/ENGLISH		1
5	A105-804-000	Key	25300000024	008 Maintenance Door		4
6	A105-805-000		25302222001	2222 Coin Box Door		2
7	A105-806-000	POT	22501000029	RV24YN 20F B502		1
8	A105-807-000	Micro Switch	22604000011	SM short sheet ZIPPY 5A 125-250VAC		2
9	A105-808-000	Micro Switch	22604000006	BLM-S 3A-125/250VAC		1
10	A105-809-000	USB	41300000003	2G		2



### 3. PART NAME

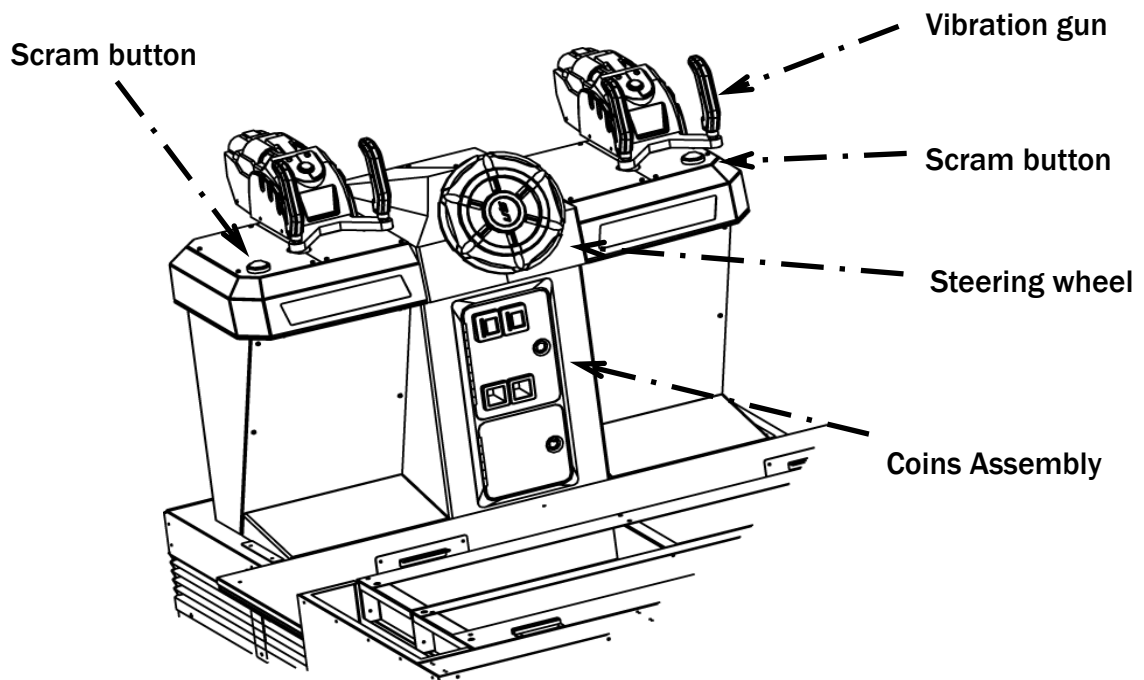
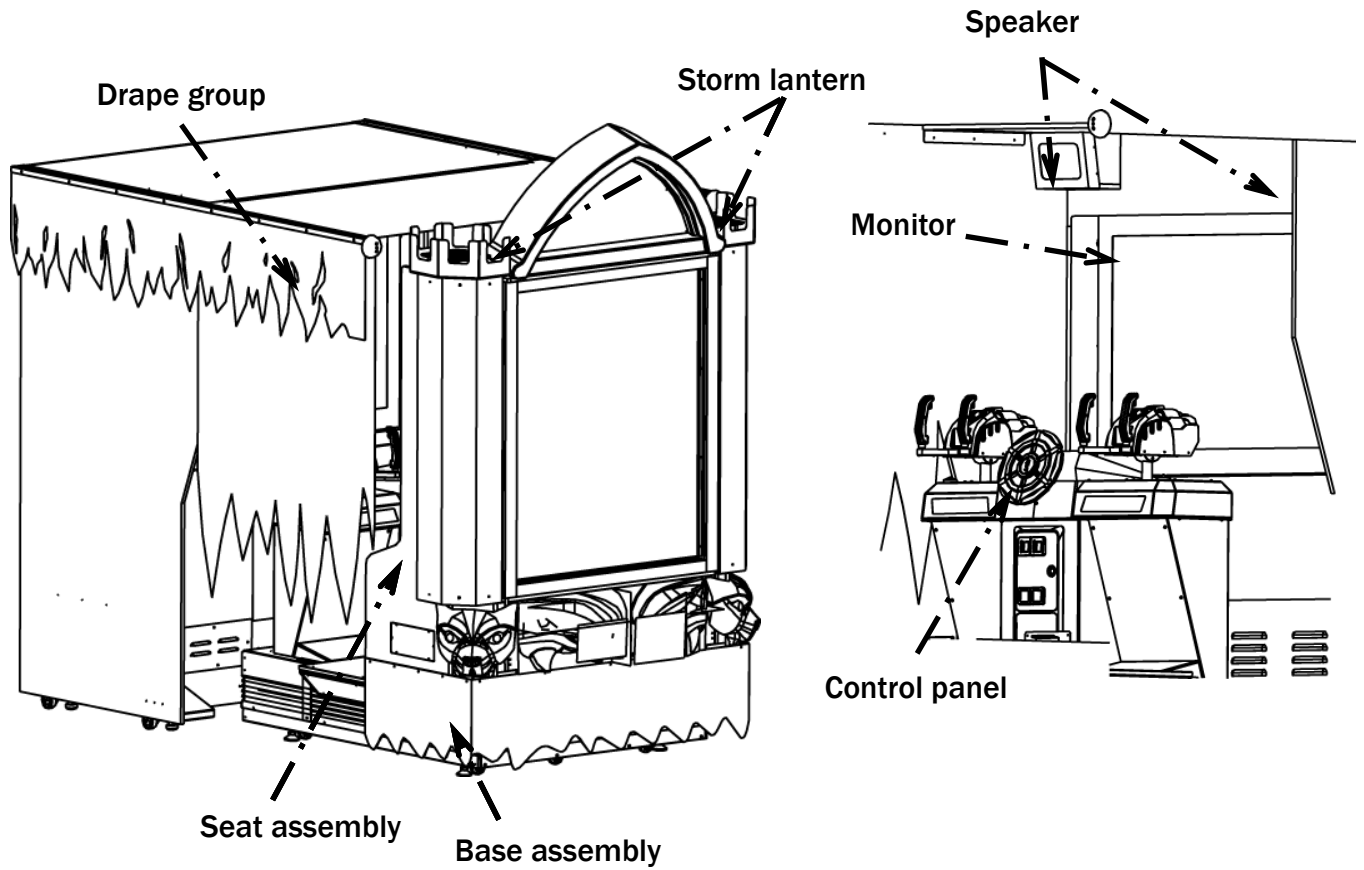



## 4. SET UP & INSTALLATION

**⚠ This product is an indoor game machine. Do not install outdoors.**

- Refer to IMPORTANT SAFETY INSTRUCTIONS (Pg. 2) for places to avoid
- Place the unit on a dry level surface
- Ventilation openings in the back of the unit must not be obstructed by objects or by wall.

### 4.1 Play Zone

This machine requires space for playing and for maintenance as shown below.

Leave space around the game upon installation:

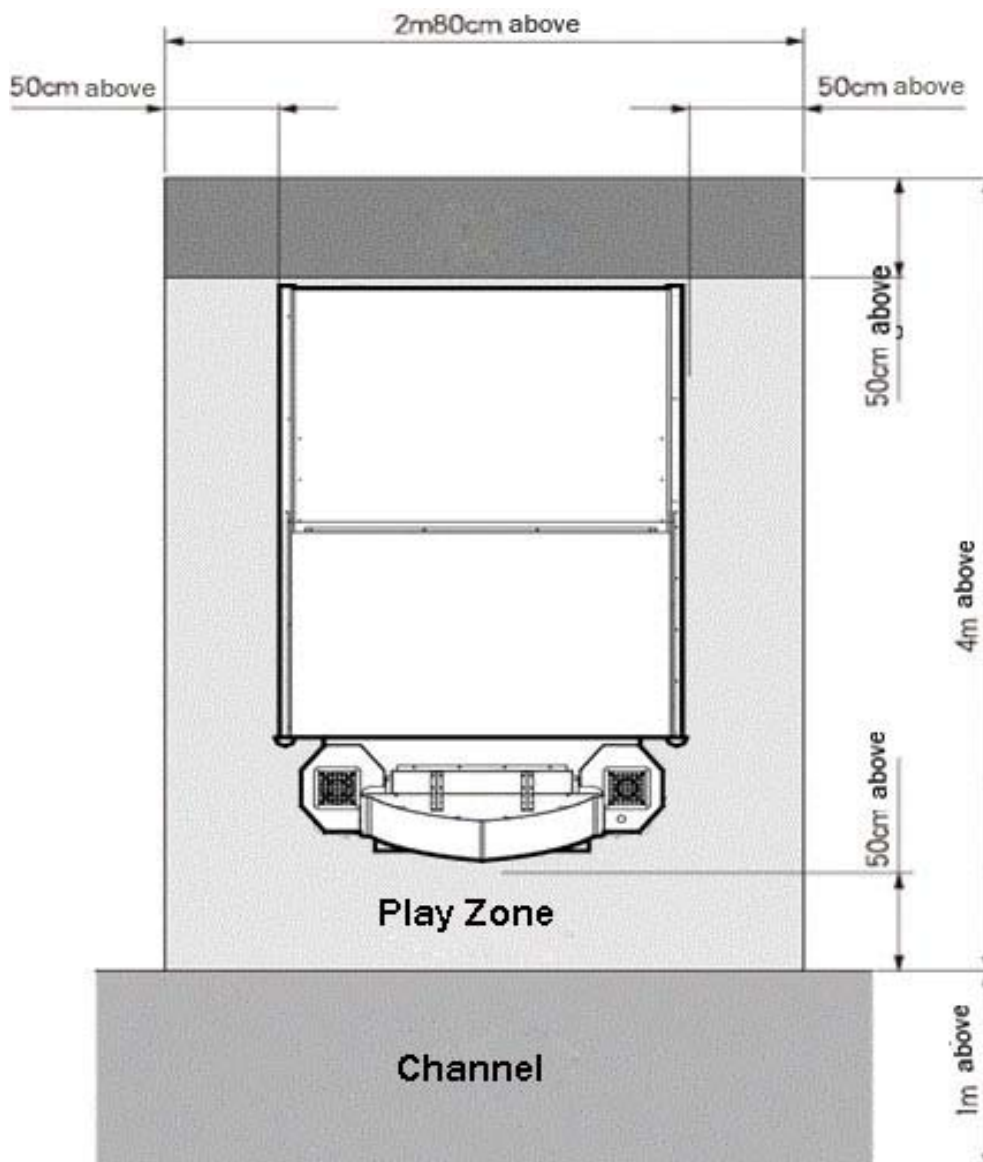

- ◇ **Notice1:** Machines do not place in inclined position, it will easily cause accidents.
- ◇ **Notice2:** Game area is different from each sticker.



## 4.2 Level Adjustment

Install this machine on a flat surface. Adjust levers to lift casters off the ground to level the game. If the game is installed on an unsuitable floor, it could cause game malfunction.

To secure the game, adjust the Leveler down until it touches the floor, lifting the casters off the ground by 5mm. Repeat the same for all levelers.

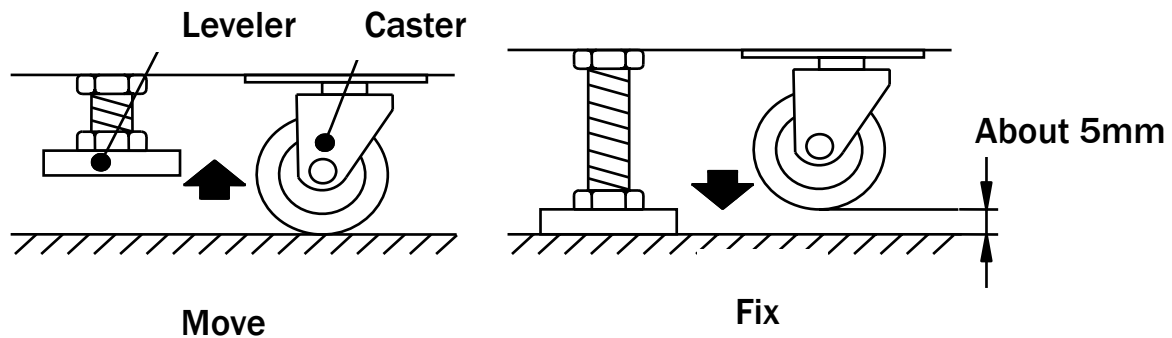

### ⚠ NOTICE

Make sure the machine is level with the ground and all the adjustable legs should stick to the floor closely.

## 4.3 Transporting the Game

If you need to move the game, adjust the levelers back to an “up” position so the casters touch the ground.

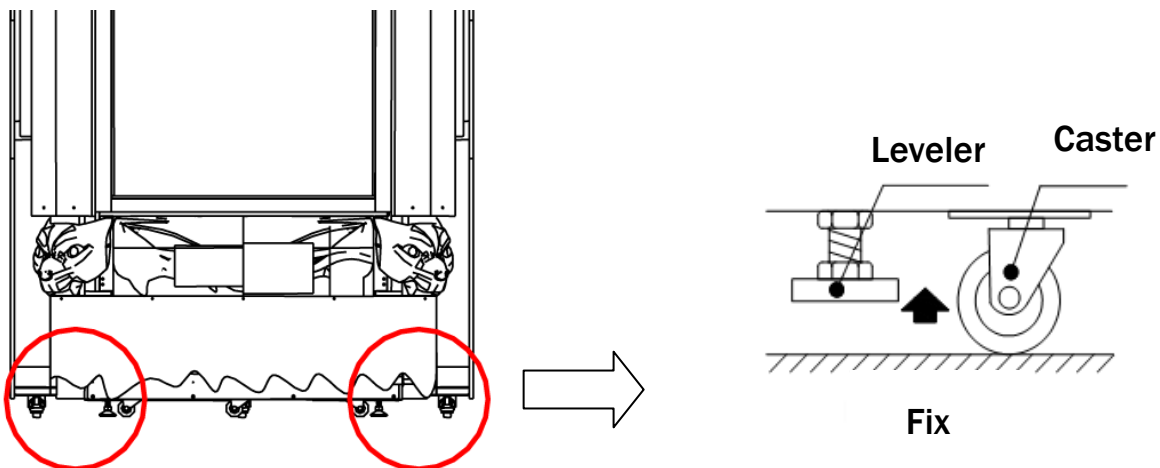

### ⚠ NOTICE

- Be careful not to damage the machine during transport.
- The machine should be handled with care when bringing it down from a higher level.
- Always unplug the game before moving.
- Keep the machine in upright position during transport.
- For longer distance transport, package the game properly to prevent damages

## 4.4 Cabinet Installation

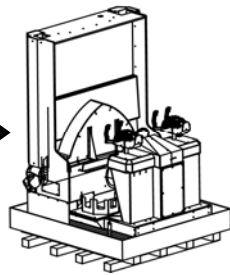
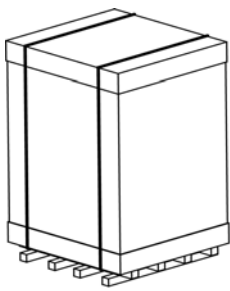

Control panel and seat assy.

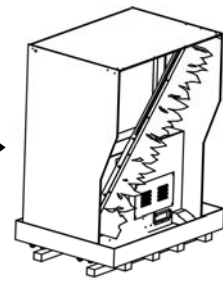
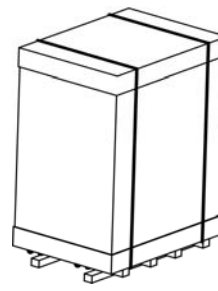

Monitor and curtain assy.

Curtain assy.

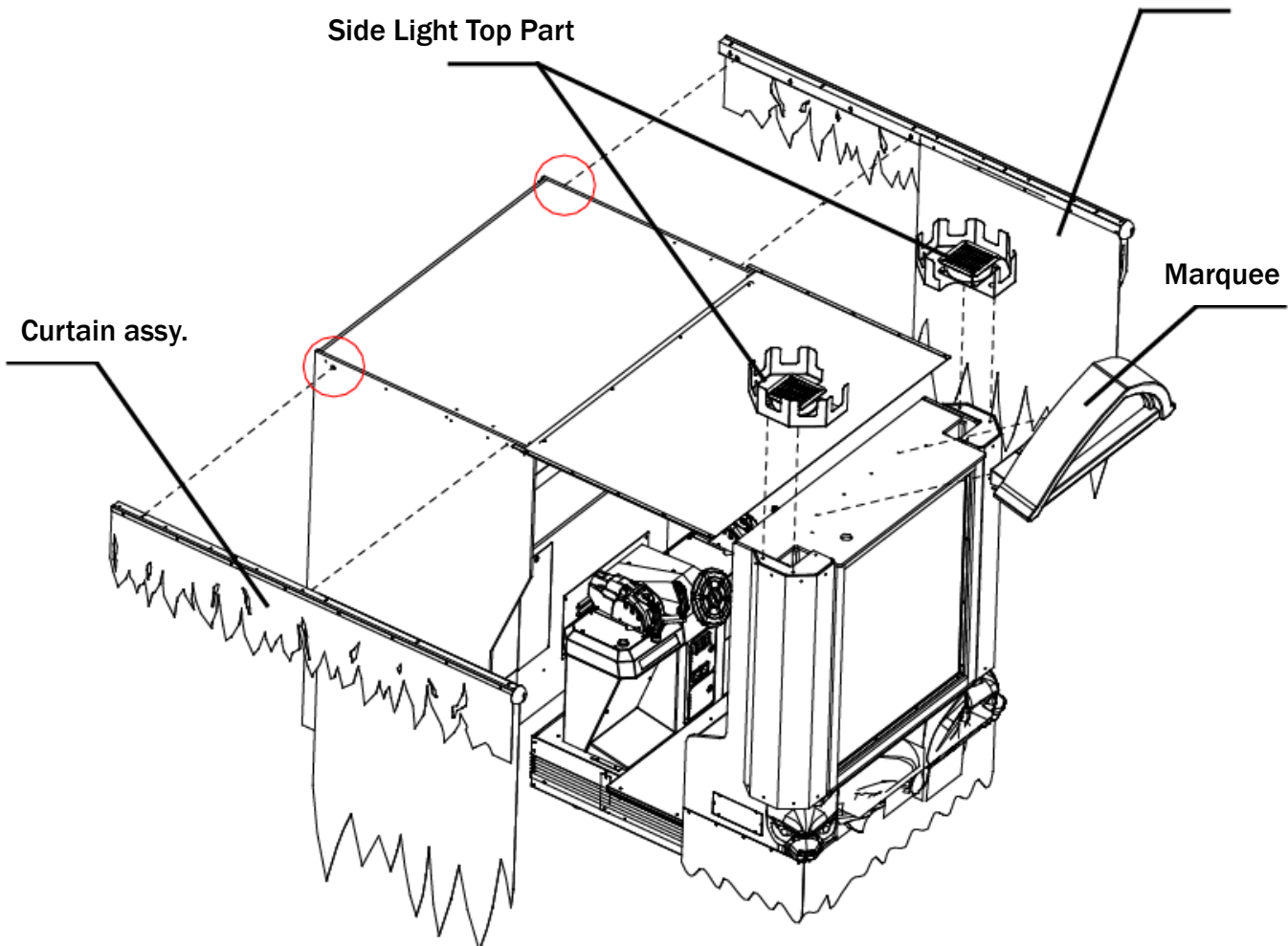

- a) Install the curtain assy., side light top part and the marquee assy, to the main cabinet as the above picture shown. Fix with screws that already prepared in the holes. Please make sure connecting the cables correctly.

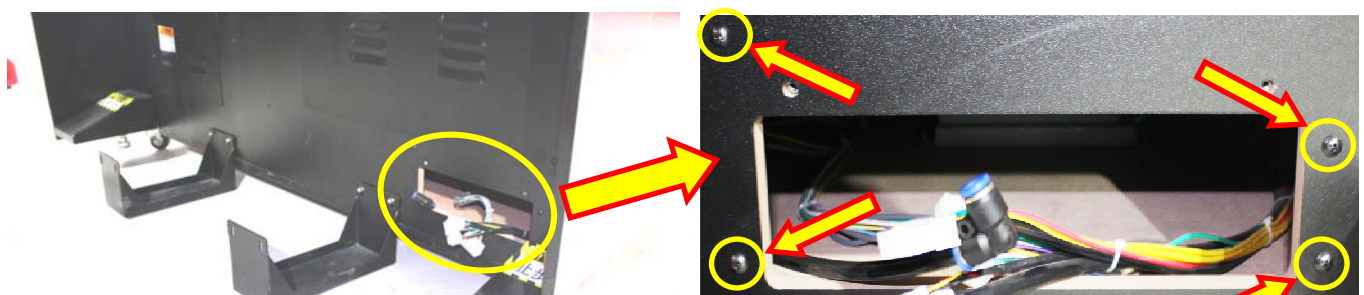



- b) pull out cables and gas-tube connector from the monitor assembly where is as above picture shown. And remove these 4 screws for stand-by.

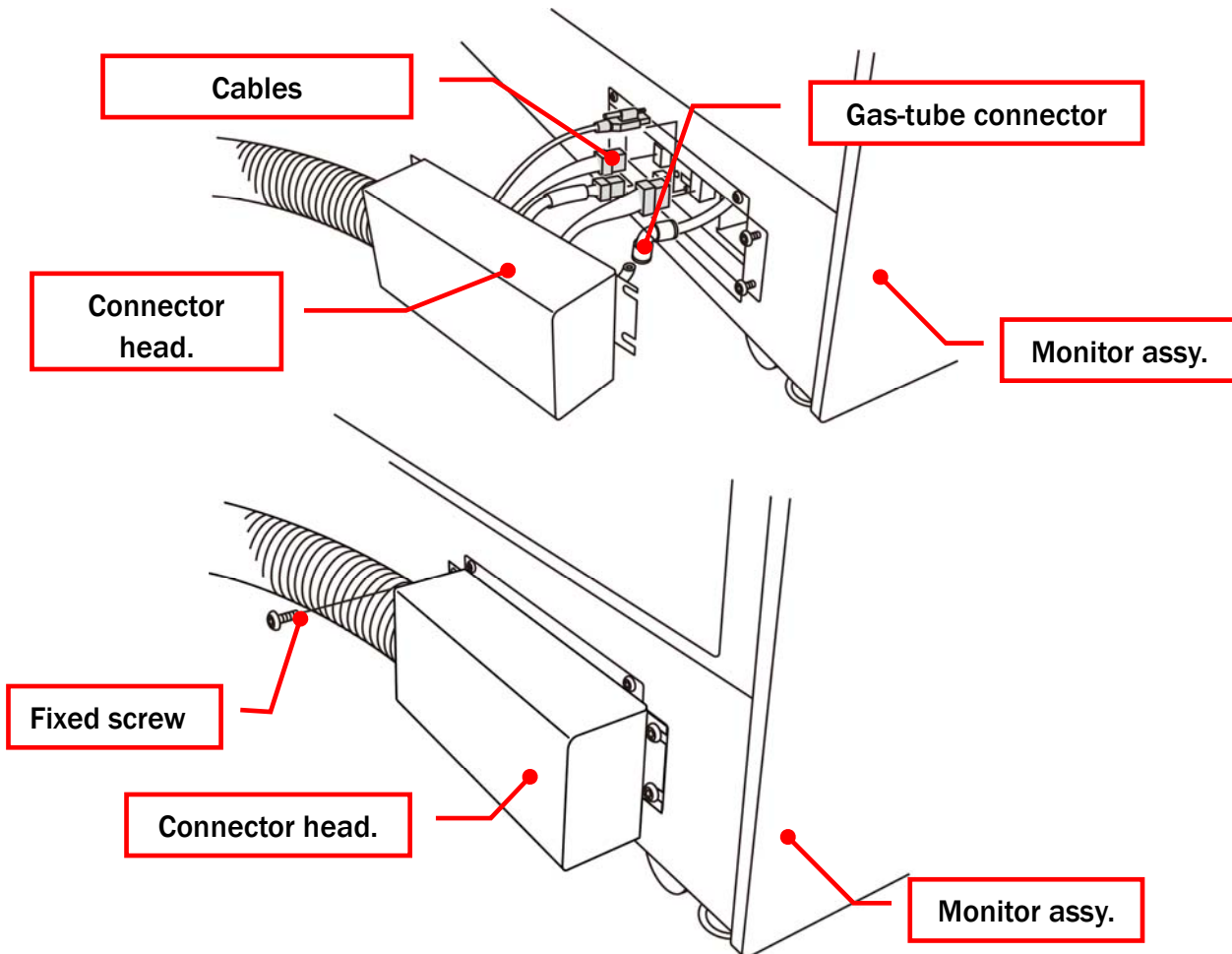

- c) Find the connector head from seat assembly. Connect the cables to the other end from monitor assy. Make sure the gas-tube is firmly connected in case gas leaking and lead to game working not properly. And then mount the connector head with screws that were prepared on Step b.



## 5. CONNECTING POWER

**⚠ WARNING:** Check the voltage rating before you connect the equipment to an electrical outlet to ensure that the required voltage and frequency match the available power source. Please refer the label of the machine.

- Do not plug the equipment power cables into an electrical outlet if the power cable is damaged.
- Avoid putting many loads on one electrical outlet as it could generate heat and fire resulting from overload.
- Connect the grounding conductor to the earth terminal (GND):

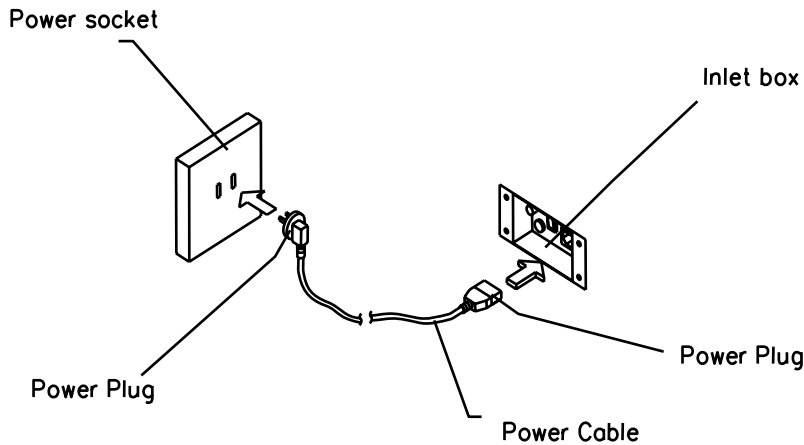

**⚠ WARNING**

Ensure no heavy objects rest on the power cord. Check to make sure the game cabinet does not sit on the power cord as this could damage the cord and become hazardous.

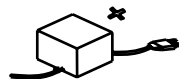

To disconnect the game, grip the plug and pull it from the wall outlet. Never pull by the cord.

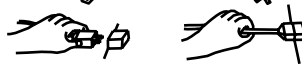

To prevent electric shock, do not touch the power plug when hand is wet.



Ensure that nothing rests on the power cord and that it is not located where it can be stepped on or tripped over.



## 6. HOW TO PLAY

### 6.1.1 Game Interface



### 6.1.2 Controller Instruction

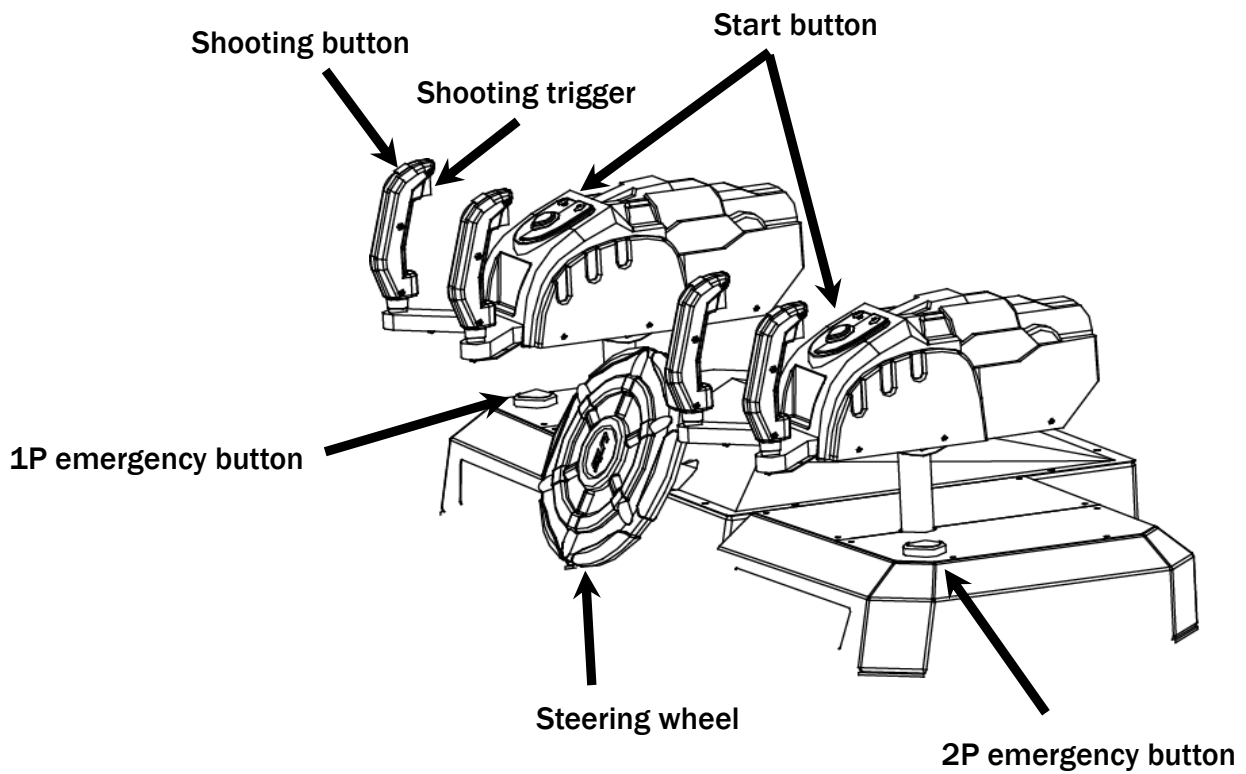

## 6.2 How to Play

### 6.2.1 Basic Rules



1. Shoot enemies, monsters and obstacles.
2. Reduce HP if you are injured and fail to follow the instructions turn the steering wheel. Game over when HP reduce to 0.



3. If appear circular target sign, please shoot it.
4. Circular target sign have normal sign and gold sign. Gold sign is difficult to destroy, please double joint attack.



5. Shoot wooden cask random covered with glowing restored HP or increase scores, increase the total score.



6. When 2 people play the game, will be evaluation match rate in the report. If skillfully joint shooting, knock down the enemies, in steering wheel scenes can skillfully out of danger, will be highly evaluation.

### 6.2.2 Operation approach



#### 1. Choose level

At the start of the game will appear levels selection screen, in 20 seconds mobile gun type controller (gun components) to move the cursor to want to levels icon, pulled the trigger can choose levels.

#### 2. Launching bullet

Trigger gun type controller (gun components) trigger or launch button, he shot a bullet. In the hold of the trigger condition, continue emission bullets.



#### 3. Control steering wheel

Control steering wheel in the game, there will be one side operating spacecraft or car, at the same time avoid enemy's attack scene, at this time will appear on the screen tip rotation wheel (steering) picture. Please accord to the instructions of the screen, out of danger.

#### (3) Start button

1. After inserting coins, then press start button to begin
2. Midway can attend.
3. In the spare time insert demonstration lens shown "according to start key jump over", by pressing the start button to skip.

#### (4) Emergency stop button

1. In the game to stop the rocking of the seat, press the emergency stop button.
2. If you want to start the rocking of the seat, please again according to the emergency stop button.
3. Seat start and stop position will be displayed on the screen.

## 7. GAME OPTIONS

### 7.1 Adjust Button Illustration

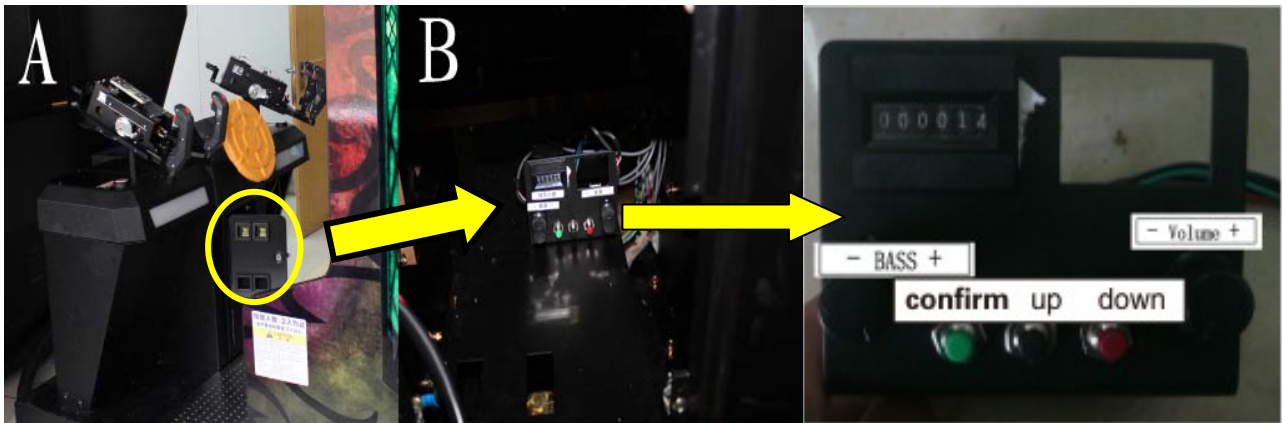

Use cash box with A key in the door open console slot (figure A circle), can see control button (diagram B, control button in order from left to right, respectively for confirmation, up and down). Press the currency bottom of the regulation on the button, and then enter into menu Settings interface.



Set in the interface options for the "set currency number" "statistical currency number" "statistical reset" "gun calibration" "IO data" "keep off". Enter setup interface, through the "button up" and "down buttons" move to want to set the options, click "confirm" button to enter setting interface can be set.



## 7.2 Gun calibration instructions

According to the method of 7-1 day enter setup interface, select "gun calibration" option, gun calibration.

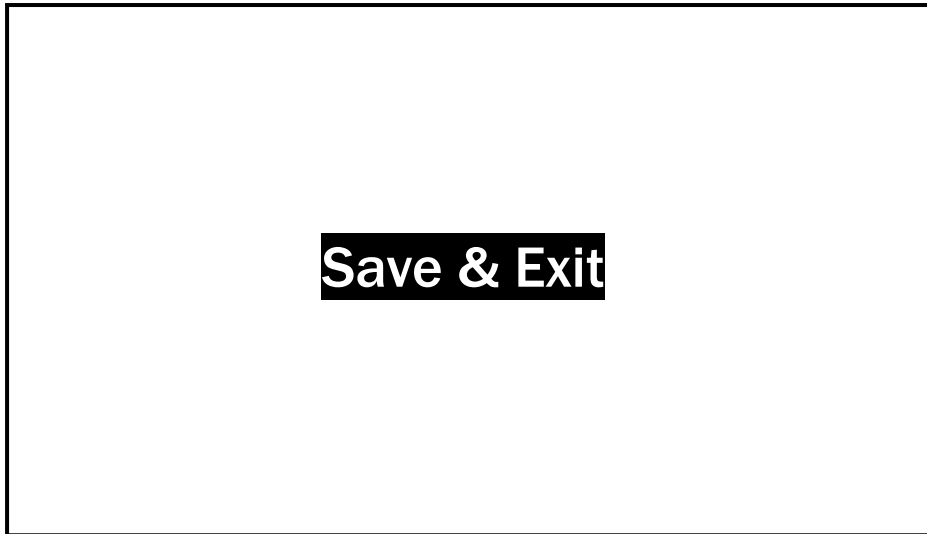

1. Enter interface will calibration vibration gun moved to the top left corner the top, when vibration gun can't move as a proper place, right now to confirm the trigger.
2. Completed the first step after the vibration gun moves to the lower right corner low, when vibration gun can't move to confirm the trigger.
3. According to the regulation of the confirm button to save exit, the gun calibration is done and be saved.

✧ **Note:** The gun calibration must be in accordance with the step order, if upset sequence can make vibration gun reverse.



## 8. ERROR MESSAGE AND RECOVERY

### 8.1 Overall

- That is in before failure; please confirm whether the connector firmly connected.

Troubles	Main reason	Elimination Method
Cannot start	Frame component connector off.	Please firmly into connector.
	rame component failure	Please contact with the distribution shop.
Action is not stable, disoperation.	Frame component fault power supply voltage at work outside voltage range.	Please remove the same line of large capacity equipment, ensure the power supply voltage of provisions
Midway dump	Circuit protector an action, the power supply switch in cutting state. (Note: in abnormal current flow, circuit protector that current cut off.	Again, please turn on the power switch. Circuit protector appeared again and again when the movement that this machine has anomaly. Please contact with the distribution shops.
Coin Mech. no reaction	Coin Mech. damage	Change coin mech.
	Coin Mech. loose signal lines	Check coin mech. signal wire is loose
	IO control panel damage	Change IO panel

### 8.2.1 Front Assembly

Troubles	Main reason	Elimination Method
The speaker does not make a sound.	Volume set is too small.	Please set the volume.
	Frame component connector off.	Please firmly into connector.
	Circuit board fault.	Please replace the circuit board.
	The speaker's fault.	Please replace the speaker.
Display picture blank screen.	Connector off.	Please firmly insert connector.
	Display fault.	Please replace the display.
Display picture bluescreen.	PC power cord loose.	Testing main power cord is loose.
	Host connected display VGA signal wire is loose.	Check the host connects the monitor of VGA signal wire is loose.
	Host graphics loose.	Disconnect host cover to pull plug graphics.
	PC into protection.	Open the machine cover, such as boot lamp has been flash, long according to boot key 30 seconds, restart machine, such as cannot solve the problem; call Lenovo national joint guarantee tel.: 8008108888.



### 8.2.2 Front Assembly

Troubles	Main reason	Elimination Method
Appear similar burnt smell.	Applied to motor over load and overheating.	Cut off the power switch; pull out the power supply plug, please contact with distribution shops.
Frequent cut off the power of the compressor.	Because of the compressor abnormalities and excessive current flow.	
Compressor without action.	Power off.	Please insert the power cord firmly.
	Thermal protector in the work.	Please click protector reset button.
	Compressor malfunction.	Cut off the power switch, pull out the power supply plug, please contact with distribution shops.
Compressor appeared excess tone, vibration, different smelly.	Screw kind of relaxation.	Please tighten the screw class.
	Compressor malfunction.	Cut off the power switch, pull out the power supply plug, please contact with distribution shops.
Not in the game, compressor or frequently work.	Air pipe falls out of the ear or not firmly insert.	Please firmly into air pipe.
The power on the game is normal, but in the operation of the can appear sometimes system halted.		Insert the new drawing graphics
	A computer crash.	Shutdown restarts or chooses system restore.

### 8.3 Seat Assembly

Troubles	Main reason	Elimination Method
The emergency stop button doesn't work.	Connector off.	Please firmly into connector.
The speaker does not make a sound.	The speaker's both set is too small.	Please to set the volume of the speaker.
	Connector off.	Please firmly into connector.
	Circuit board fault.	Please replace the circuit board.
Base component can't move.	Air pipe fall off. Or not firmly insert.	Please firmly into air pipe.
	Pneumatic valve fault.	Please replace the air valve.
	Compressor fault.	Cut off the power switch; pull out the power supply plug, please contact with distribution shops.



## 8.4 Control Assembly

Troubles	Main reason	Elimination Method
Gun doesn't work.	POT does not initialized.	Please be initialized.
	Connector off.	Please firmly into connector.
	Potentiometer installation error.	Please properly installed potentiometer.
	POT fault.	Please replace the potentiometer.
Trigger failure.	Connector off.	Please firmly into connector.
	The trigger of the micro switch fault.	Please replace the micro switch.
Start button doesn't work.	Connector off.	Please firmly into connector.
	Connector off.	Please replace the start button.
Guns don't vibration.	Circuit board fault.	Please replace the circuit board.
	Vibration component failure.	Please replace the vibration module.
The steering wheel failure.	Connector off.	Please firmly into connector.
	Photoelectric sensor fault.	Please replace the photoelectric sensor.
Gun interior error.	Accuracy position error.	Please calibration gun components.
	Front sight reverse.	Calibrate gun sequence backward.

## 8.5 Error Message

**Symptom:** Screen displays message "**Communication ERROR**" (there is communication problem with the game)

**Possible Causes & Fixes:**

- Communication data wire is damaged → Replace the data wire.
- SCM is not working → Ask your technician to check and repair
- PC COM port has been used → Ask your technician to check and repair

**Symptom:** Screen displays "**PLEASE CALL ATTENDENT**", "**TICKET ERROR**" (there is problem in the ticket payout function)

**Possible Causes & Fixes:**

No tickets in the game → Replenish tickets and then press the TICKET RESET button.

Ticket dispenser is damaged → Replace with a new ticket dispenser.

Faulty connection → Ask the technician to check and repair.



## 8.6 System Recovery Operation

1. Turn off the game. Insert the memory stick into the USB port at the back of the computer.
2. Restart PC to enter the system recovery screen as shown.

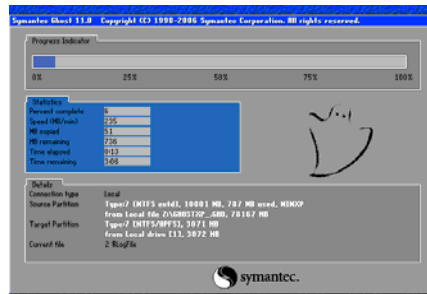

3. The game will automatically start recovery which will take last about 5 minutes. Please wait until process is complete.
4. Once system recovery is finished (as shown below), remove the USB flash drive from the computer and turn off the PC. Wait at least 30 seconds before restarting the PC.

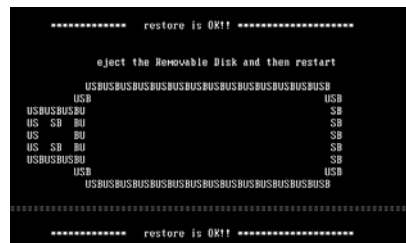

**⚠ WARNING:** the USB flash drive should only be used to fix software errors. Using it for other purposes may cause unexpected results and damages.



## 9. MAINTENACE AND DIRECTIONS

### 9.1 Safety detection, please check the following before starting

- Power parameters are consistent with the machine.
- Machine warning signs are clearly visible.
- Machine place whether smooth, casters and top feet regulation is appropriate.
- Machine placed area is appropriate.
- Power plug whether accumulation have dust.
- Seat assembly if there is damage.
- Base assembly safety cover for damage
- Drape components when bending pipe, tube caps are damaged.

Please check the following projects after turning on power switch. When abnormal, please immediately cut off the power switch, stop running. After that, pull out the power supply plug from the socket, and distributors to contact.

- Part of the power cord, plug whether anomaly fever?
- Such as touch main body, whether to have the contact limp and numb feeling?
- Have coke flavor, abnormal sound, vibration?
- Whether there are other anomaly, fault?
- Emergency stop button if it can work normally?

### 9.2 Installation and Debugging

- Before installation, please click list verification parts, components assembly.
- Use site must level off strong, the machine when in place to adjust seat transferred to the ground level fixed.
- Installation is completed, plug in the power cord boot, check the machine parts operation is normal or not, such as the discovery of abnormal phenomenon, timely stop unblocked.

### 9.3 Compressor Inspection project

Please check the following projects on a daily basis:

- Compressor drainage discharge processing.
- compressor excess tone, vibration, smelly confirmation
- Filter regulator of the set pressure inspection

## 9.4 Compressor Drainage Discharge Processing

If negligence drainage discharge processing, water will enter pressure movable part and cause failure.

In addition, the air of rust cannot discharge, can cause filter regulator and air compressor parts anomaly, cause failure.

**A.** Cut off the power, automatically discharge air in compressor.

**B.** Cut off the power, after about 2 minutes, use the accessory maintenance with key remove lock, then open filter door.

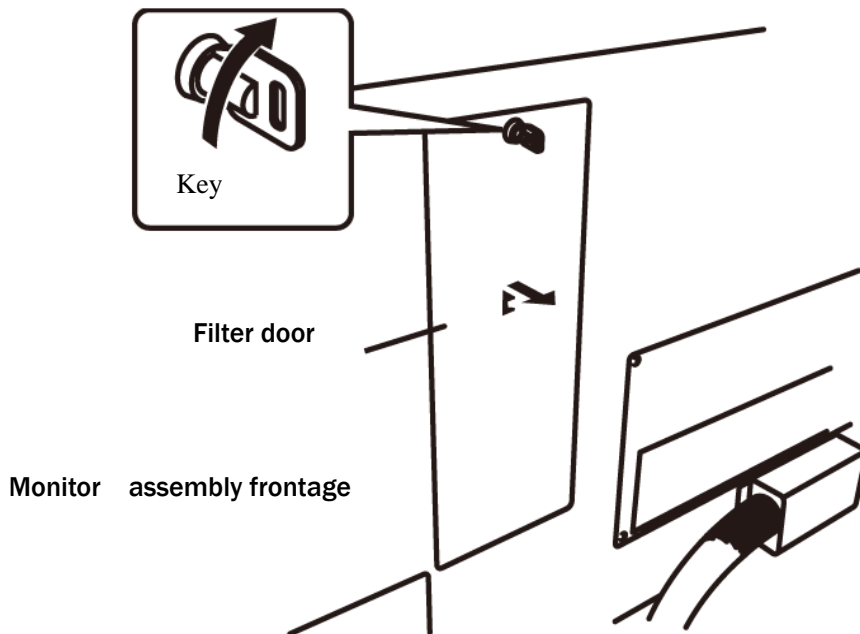

**C.** Please manually drainage by press the position as shown.





**D. Take out the drainage box, and pour away the water.**

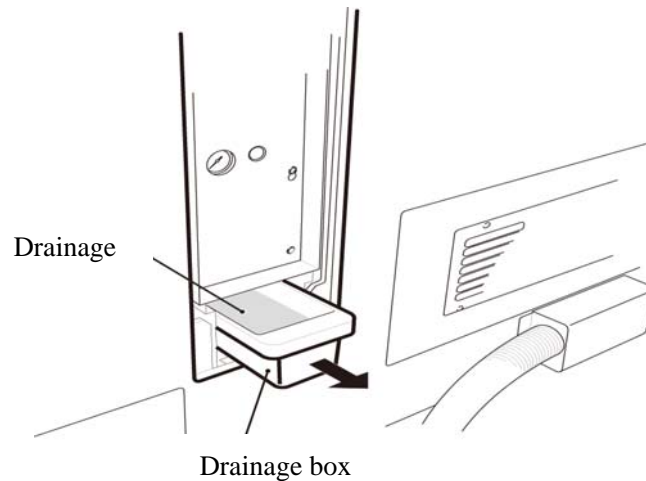

- ✧ **Note1:** Please be sure to check the timing and drainage discharge.
- ✧ **Note 2:** Container avoid contact with thinner, carbon tetrachloride, kerosene and other organic solvents, avoid direct sunlight.

### 9.5 Filter adjustment detection of set up pressure

- A.** Turn on power, waiting compressor stops. (About 4 minutes).
- B.** Use of the maintenance subsidiary with keys to open filter door and confirm the filter adjustment of the location of the array. 0.60 Mpa is normal.

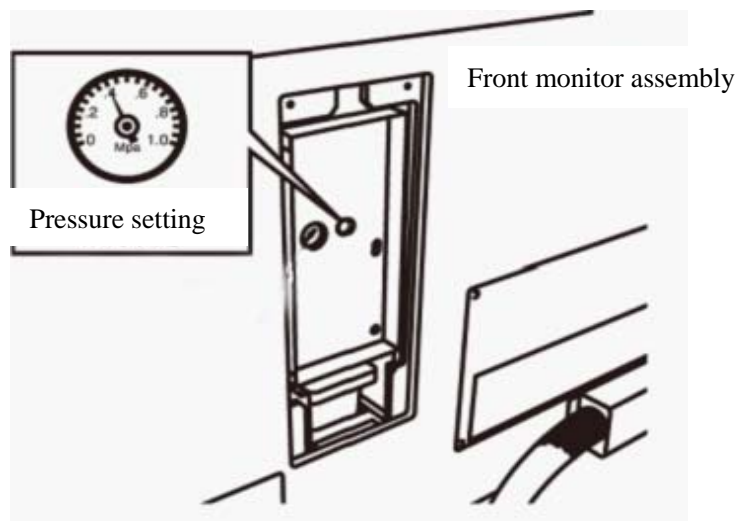

**C.** When pressure is off the normal range, please entrust technical person to inspect.

### 9.6 Maintenance

- Before every day in business, should first trial running normal rear can use.
- When machine have dirt dust, use a soft cloth with detergent to wipe.
- New machine running after a month must check a various parts is normal or not.
- Check machine often.



## Warning

- **Before servicing the machine, be sure to turn power off.**  
In order to avoid a short circuit, the relevant persons should contact with the internal device before shut off the power, If the operation requires electrical source on, it must be in accordance with the requirements of the operating instructions.
- **Choose appropriate accessories when replacing device.**  
Use the incorrect accessories may lead to electrical short circuit, damage main board and components.
- **Don't open the baggage hold, assembly, changes the equipments literally.**  
It could lead to electrical short circuit, mechanical failure, etc., or may cause fire.
- **Don't place vase, cups, and containers with water on the machine, also the chemicals and weights.**  
Overflow liquid can lead to electrical short circuit and damage device, at the same time, high altitude fallen will harm the human body and damage the machine.
- **Don't place article at the air outlet.**  
Blocking outlet will cause the internal temperature rise, affect normal working, even damage device.
- **Don't repair machine at will.**  
This may cause short circuit or operating out of control and fault.
- **Don't pull drape assembly.**  
This may cause drape assembly damaged or even damage players.
- **It's not allowing 3 players for the game at the same time.**  
It could damage machines.



# 10. OVERALL CONSTRUCTION

## 10.1 Mechanical Part

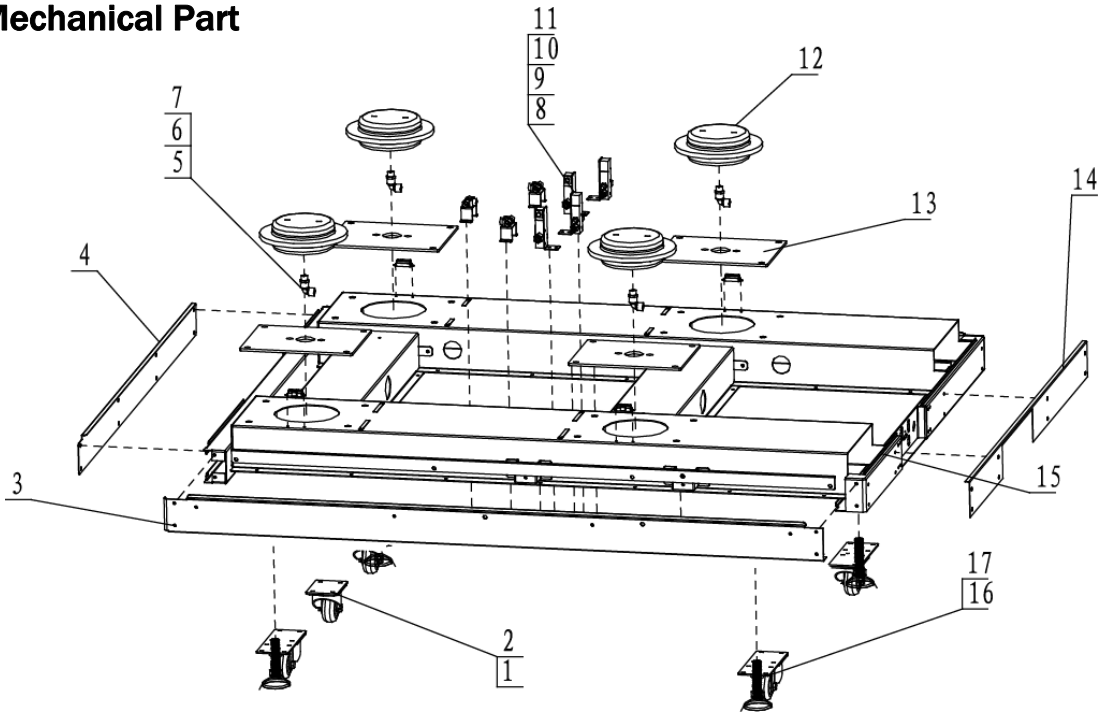

No.	Part No.	Code No.	Name	Spec.	Qty
1	A105-101-000	20241207014	Caster fixed plate	Q235/δ3.0powder black	1
2	A105-401-000	25501000056	2.5'caster	3-2689-52	5
3	A105-102-000	20241207017	Base side cover	Q235/δ1.0powder black	2
4	A105-103-000	20241207016	Base back cover	Q235/δ1.0powder black	1
5	A105-402-000	25101020151	10 Bending gas connecter	DN10 3/8inch	4
6	A105-403-000	25101111003	10mm pipe-1/8 inch External wire directly	10mm pipe-1/8 inch External wire directly	4
7	A105-404-000	25106020195	10mm pipe		6
8	A105-405-000	25101030080	8 Tee quick joint	DN8 1/4inch	3
9	A105-406-000	25101111001	8mm pipe-1/8 inch External wire directly	8mm pipe-1/8 inch External wire directly	4
10	A105-407-000	20841207002	Silencer	SLW-6A 1/8	4
11	A105-408-000	25106020194	8mm pipe		6
12	A105-409-000	20841207001	air spring	W01-M58-5030	4
13	A105-104-000	20241207013	Cylinder plate	Q235/δ5.0Powder black	4
14	A105-105-000	20241207015	Base front cover	Q235/δ1.0Powder black	1
15	A105-106-000	20241207116	Base welding	Q235/Powder black	1
16	A105-410-000	20241013042	Leveler	Q235/M16/Color-Zinc	4
17	A105-411-000	26000010000	2.5'Leveler bracket	Q235/δ3(Color-Zinc)	4



## 10.2 Up Base Assembly

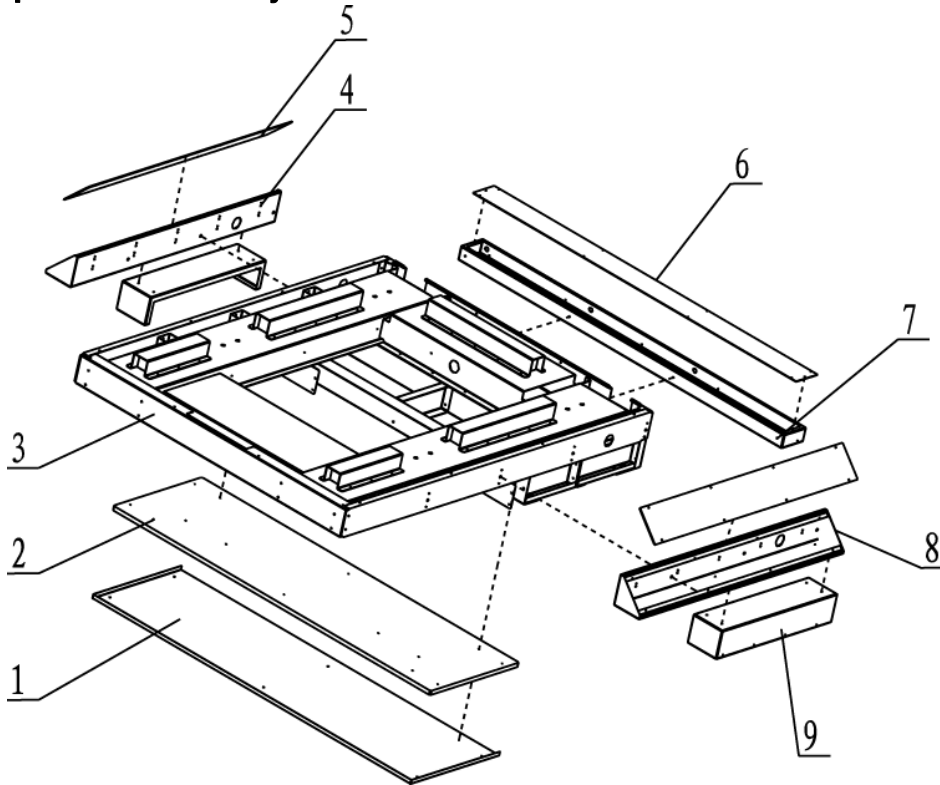

No.	Part No.	Code No.	Name	Material/Spec.	Qty
1	A105-501-000	20341207060	Pedal	MDF / $\delta$ 15	1
2	A105-107-000	20241207042	Pedal plate	sha-steel/ $\delta$ 1.2	1
3	A105-108-000	29941207013	Up base welding group	Q235/ Powder black	1
4	A105-109-000	20241207044	Pedal L-plate	Q235/ $\delta$ 1.5 Powder black	1
5	A105-601-000	20641207002	Base chimney	Organic slice (white) / $\delta$ 3.0	2
6	A105-602-000	20641207001	Back light base chimney	Organic slice (white) / $\delta$ 3.0	1
7	A105-110-000	20241207043	Back light base	Q235/ $\delta$ 1.5 Powder black	1
8	A105-111-000	20241207045	Pedal R-plate	Q235/ $\delta$ 1.5 Powder black	1
9	A105-112-000	20241207040	Base wheel chimney	Q235/ $\delta$ 1.0 Powder black	2



### 10.3 Control Panel

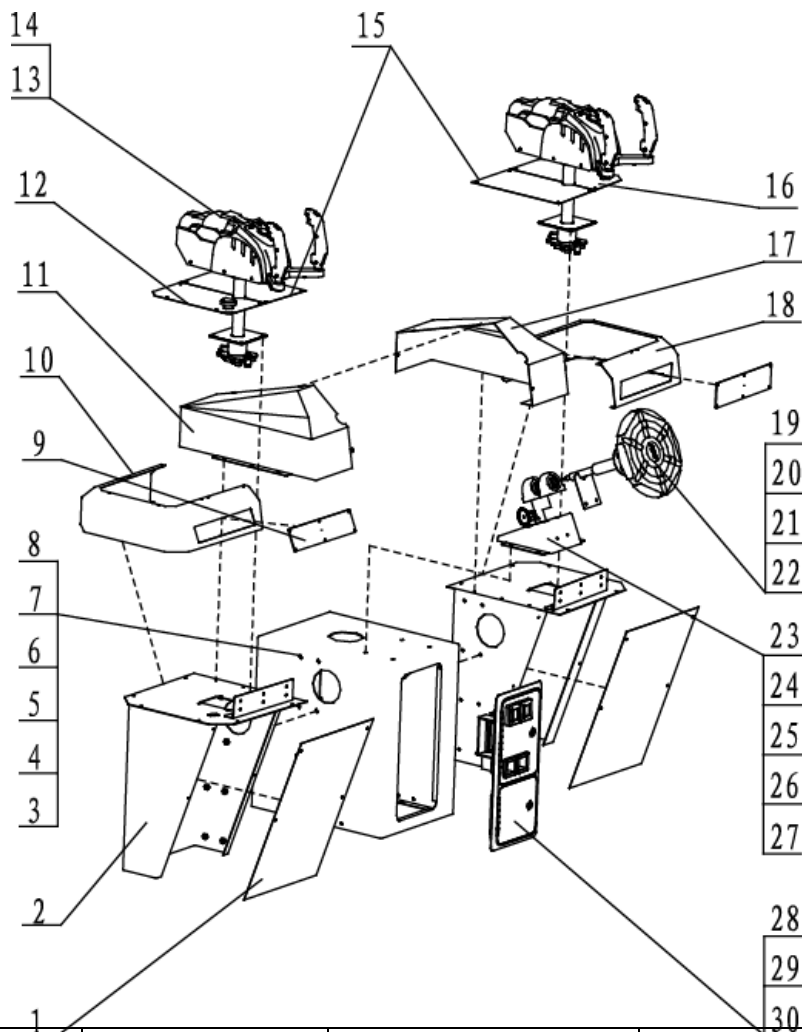

No.	Part No.	Code No.	Name	Material/Spec.	Qty
1	A105-113-000	20241207053	Side control panel cover board	Q235/δ1.0 Powder black	2
2	A105-114-000	20241207052	L-control panel	Q235/δ3.0 Powder black	1
3	A105-115-000	20241207058	M-control panel	Q235/δ3.0 Powder black	1
4	A105-116-000	20241207059	Control panel board	Q235/δ1.0 Powder black	1
5	A105-117-000	26000026000	Outside coin box	Q235/δ1.5	1
6	A105-118-000	26000025000	Inner coin box	Q235/δ1.2	1
7	A105-119-000	20241113033	Counter bracket	Q235/δ=1.5, Powder black	1
8	A105-502-000	20341207059	IO board base	Double black fiber board/δ15	1
9	A105-603-000	20241207055	Side cover organic slice	Plastic(white)/δ3.0	2
10	A105-120-000	20241207051	L-control panel shade	Q235/δ1.0 Powder black	1
11	A105-121-000	20241207047	M-control panel shade	Q235/δ1.5 Powder black	1
12	A105-122-000	20241207050	L-side cover shade	Q235/δ1.5 Powder black	1



No.	Part No.	Code No.	Name	Material Spec.	Qty
13	A105-001-000	141123	Vibration gun assembly	Assembly	2
14	A105-123-000	20241207046	Gun base	Q235/δ3.0Powder black	2
15	A105-124-000	20241207049	Side shade cover	Q235/δ1.5Powder black	2
16	A105-125-000	20241207054	R-side shade cover	Q235/δ1.5Powder black	1
17	A105-126-000	20241207048	M-shade cover	Q235/δ1.5Powder black	1
18	A105-127-000	20241207056	R-control panel shade	Q235/δ1.0Powder black	1
19	A105-128-000	20241207062	Steering wheel	Q235/Powder black	1
20	A105-604-000	20241207063	Control panel rudder	PU	1
21	A105-412-000	20106130015	Insert bearing	UCPA2/204	2
22	A105-129-000	20241207065	Steering wheel location-plate	Q235/δ1.0Powder black	1
23	A105-130-000	20241207064	Steering wheel base	Q235/δ2.0Powder black	1
24	A105-605-000	20641207003	Infrared base	POM black/δ10	1
25	A105-131-000	20241207060	Infrared fixed board	SECC/δ1.2	1
26	A105-132-000	20241207061	Index plate	SECC/δ1.0	1
27	A105-133-000	20241207057	R-control panel	Q235/δ3.0Powder black	1
28	A105-413-000	25300000024	008 Lock	008Lock	1
29	A105-414-000	25302222001	Lock	2222	1
30	A105-002-000	26000017000	Single vertical coin door	Assembly(Powder black)	1





No.	Part No.	Code No.	Name	Material/Spec.	Qty
1	A105-606-000	20541207004	Lamp standard L-decal	δ5Transparent slice/578*1318	1
2	A105-134-000	20241207099	Lamp standard R-up cover	Q235/δ1.5Powder black	1
3	A105-135-000	20241207103	Marquee fixed base	Q235/δ1.5Powder black	2
4	A105-503-000	20341207057	Marquee board	Double black fiber board/δ15	1
5	A105-136-000	20241207106	Up light bar base	SECC/T=1.0	6
6	A105-607-000	20541207C001	Top marquee decal	δ3Transparent slice/803*368	1
7	A105-608-000	20241207107	Marquee	ABS black/δ5.0	1
8	A105-137-000	20241207105	Lamp-chimney fixed base	SECC/T=2.0	6
9	A105-138-000	20241207104	Marquee fixed bottom base	Q235/δ1.5Powder black	1
10	A105-415-000	20841207003	Storm lantern	Assembly	2
11	A105-139-000	20241207117	L-lamp standard top cover	Q235/δ1.5Powder black	1
12	A105-140-000	20241207118	Light bar base	Q235/δ2.0Powder black	2
13	A105-609-000	20541207004	L-side lamp standard decal	δ5Transparent slice/578*1318	1
14	A105-141-000	20241207114	Back base side cover	Q235/δ1.0Powder black	2
15	A105-416-000	20641207013	Seat down fabric	Double black nylon fabric /δ=0.2	1
16	A105-417-000	20541207019	Back base dossal	0.3High precision waterproof cloth/2590*330	1
17	A105-504-000	20341207052	Back cushion board	Double black fiber board	1
18	A105-505-000	20341207053	Seat cushion board	Double black fiber board/δ15	1
19	A105-506-000	20341207061	Speaker fixed plate	Double black fiber board/δ15	1
20	A105-142-000	26000027000	4'speaker net	Q235/net-board /δ=0.5mm	2
21	A105-507-000	20241207113	Seat cushion	Wood +foam	1
22	A105-508-000	20241207112	Back cushion	Wood +foam	1
23	A105-143-000	20241207120	Low sound speaker net	Q235 net-board /δ1.0	1
24	A105-003-000	29941207C004	Backseat wooden cases	Assembly	1
25	A105-144-000	20241207110	Eye light bracket	SECC/δ1.0	2



No.	Part No.	Code No.	Name	Material/Spec.	Qty
26	A105-145-000	20241207111	Light bracket	SECC/δ1.0	1
27	A105-146-000	20241207108	Down light bar base	SECC/δ1.5	4
28	A105-610-000	20241207102	R-hammer	ABS black/δ5.0	1
29	A105-147-000	20241207101	Marquee short platen	Q235/δ1.0 Powder black	2
30	A105-611-000	20541207C002	Middle marquee decal	δ5 Transparent slice/959*1152	1
31	A105-612-000	20241207098	Middle shade	ABS black/δ5.0	1
32	A105-509-000	20341207051	Blister base board	Double black fiber board/δ15	1
33	A105-148-000	20241207115	Back fixed block	SECC/δ2.0	4
34	A105-149-000	20241207100	Marquee long platen	Q235/δ1.0 Powder black	2
35	A105-150-000	20241207109	Top light bar base	SECC/T=1.0	12
36	A105-613-000	20241207097	L-hammer	ABS black/δ5.0	1



### 10.5 Back wooden box

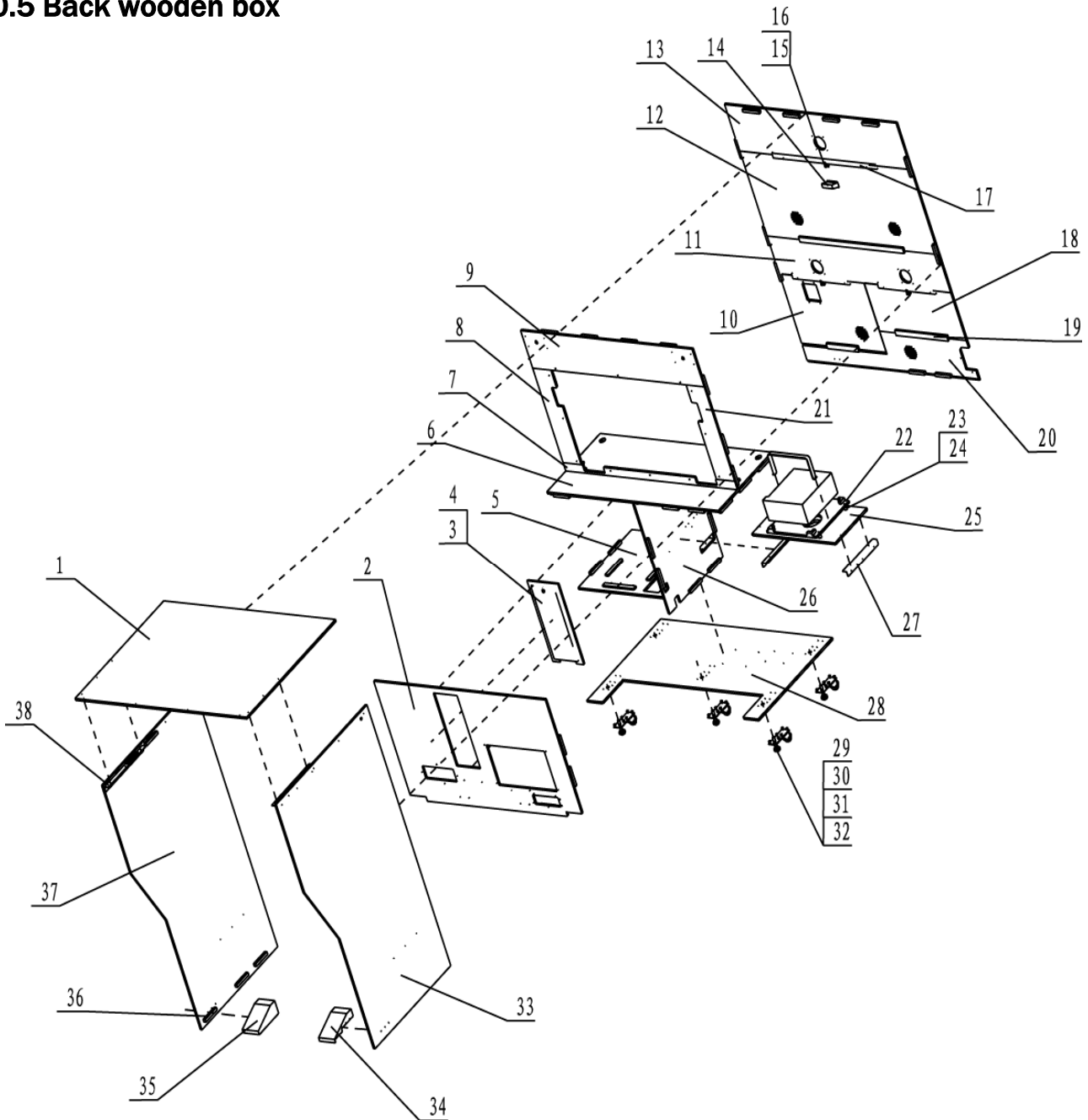

No.	Part No.	Code No.	Name	Material/Spec.	Qty
1	A105-510-000	20341207021	Top board	MDF/ $\delta$ =15	1
2	A105-511-000	20341207027	Front board	MDF/ $\delta$ =15	1
3	A105-512-000	20341207026	Front door	MDF/ $\delta$ =15	1
4	A105-513-000	20341207041	Door card board	MDF/ $\delta$ =15	1
5	A105-514-000	20341207044	Empty press plate	Plywood / $\delta$ =15	1
6	A105-515-000	20341207024	Middle board	MDF/ $\delta$ =15	1
7	A105-516-000	20341207040	Monitor down board	MDF/ $\delta$ =15	1
8	A105-517-000	20341207037	Monitor L-side board	MDF/ $\delta$ =15	1



No.	Part No.	Code No.	Name	Material/Spec.	Qty
9	A105-518-000	20341207036	Front up board	MDF/ $\delta$ =15	1
10	A105-519-000	20341207031	Empty press door	MDF/ $\delta$ =15	1
11	A105-520-000	20341207032	Back middle board	MDF/ $\delta$ =15	1
12	A105-521-000	20341207023	Monitor door	MDF/ $\delta$ =15	1
13	A105-522-000	20341207022	Back up board	MDF/ $\delta$ =15	1
14	A105-418-000	25102000098	Black plastic suction hand	ABS	1
15	A105-419-000	25300000024	008 Lock	008Lock	4
16	A105-151-000	20241207071	008 lock slice	Q235/ $\delta$ =2.5,MF-Zn	4
17	A105-523-000	20341207039	Long baffle	MDF/ $\delta$ =15	1
18	A105-524-000	20341207033	PC door	MDF/ $\delta$ =15	1
19	A105-525-000	20341207034	Baffle	MDF/ $\delta$ =15	2
20	A105-526-000	20341207035	Back down board	MDF/ $\delta$ =15	1
21	A105-527-000	20341207038	Monitor R-side board	MDF/ $\delta$ =15	1
22	A105-528-000	20341207C005	PC base board	MDF/ $\delta$ =15	1
23	A105-420-000	26000013000	Shockproof screw B	Assembly/bolt , Color-Zinc	4
24	A105-152-000	20102020012	Hexagon nut with flange	Q235/M6 Color-Zinc	4
25	A105-529-000	20341207043	Computer supported plate	MDF/ $\delta$ =15	1
26	A105-530-000	20341207025	Median septum	MDF/ $\delta$ =15	1
27	A105-153-000	20241207074	Support angle iron	Q235/ $\delta$ =3,Powder black	2
28	A105-531-000	20341207030	Base plate	Plywood/ $\delta$ =15	1
29	A105-421-000	25501000056	2.5'caster	3-2689-52	5
30	A105-422-000	26000008000	2.5'leveler	Q235/M16X100(Color-Zinc)	5
31	A105-423-000	26000010000	2.5'castor bracket	Q235/ $\delta$ 3(Color-Zinc)	5
32	A105-154-000	20104020004	Cross recess hexagon head screw kit	Q235/M6 $\times$ 25 Color-Zinc	40
33	A105-532-000	20341207C003	L-side board	MDF/ $\delta$ =15	1
34	A105-155-000	20241207072	L-cover	Q235/ $\delta$ =3,Powder black	1
35	A105-156-000	20241207073	R-cover	Q235/ $\delta$ =3,Powder black	1
36	A105-533-000	35201001150	Wood	20 $\times$ 20 $\times$ 150	79
37	A105-534-000	20341207C004	R-side board	MDF/ $\delta$ =15	1
38	A105-157-000	20241207070	Angle-bar joint	Q235/ $\delta$ =2,Powder black	2



## 10.6 Monitor Assembly

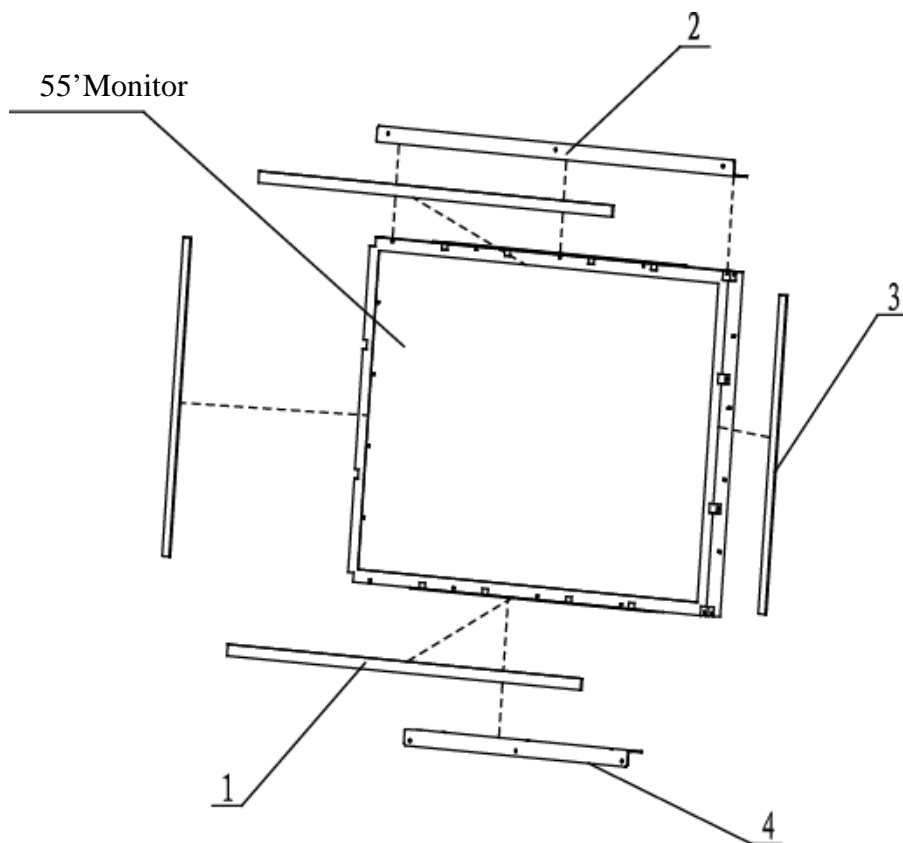

No.	Part No.	Code No.	Name	Material/Spec.	Qty
1	A105-614-000	20241207076	Monitor fluctuation strip	block gine (black)/ $\delta=3$	2
2	A105-158-000	20241207075	Monitor up support bracket	SECC/ $\delta=2$	1
3	A105-615-000	20641207004	Monitor L&R strip	block gine (black)/ $\delta=3$	2
4	A105-159-000	20241207077	Monitor down support bracket	SECC/ $\delta=2$	1



## 10.7 Dewatering

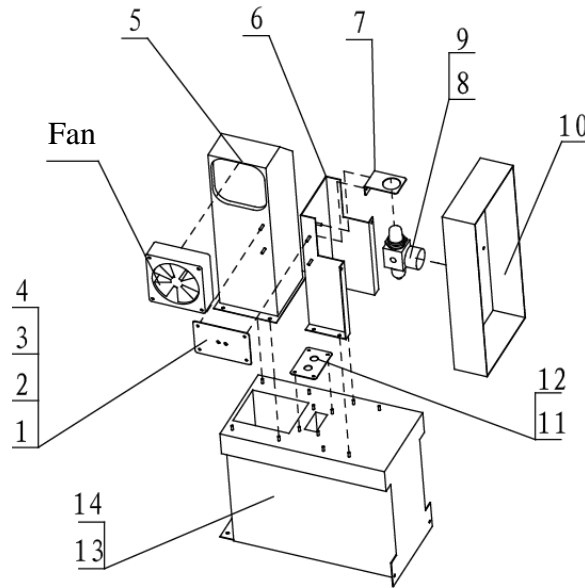

No.	Part No.	Code No.	Name	Material/Spec.	Qty
1	A105-424-000	20241013089	Normally closed electromagnetic valve bracket	SECC/ $\delta$ 1.6	1
2	A105-425-000	25101120044	Normally open electromagnetic valve	220V 15W	1
3	A105-426-000	25101110010	6mmpipe-1/4 inch External wire directly	6mm Pipe-1/4'External wire directly	1
4	A105-427-000	25101111002	8mm pipe-1/4 inch External wire directly	8mmPipe-1/4'External wire directly	3
5	A105-428-000	20241013012	Smoke ram	Q235/ $\delta$ 1/Powder black	1
6	A105-160-000	20241207080	Valve big bracket	Q235/ $\delta$ =1.5,Powder black	1
7	A105-161-000	20241207079	Pressure reducing valve bracket	SECC/ $\delta$ =2	1
8	A105-429-000	25101111002	8mmpipe-1/4 inch External wire directly	8mmPipe-1/4'External wire directly	3
9	A105-430-000	25101123002	Filter valve	AW2000-02 G1/4	1
10	A105-431-000	20241013086	Instrument baffle	SECC/ $\delta$ 1.2	1
11	A105-432-000	20241013008	Leaking roof	Q235/ $\delta$ 1.6/Powder black	1
12	A105-433-000	25101112011	6mmpipe1/4inchSymmetric external wire directly	6mmPipe-1/4'-6mmPipe	1
13	A105-434-000	20241013007	Tank seat	Q235/ $\delta$ 1.0/Powder black	1
14	A105-435-000	20241013075	Joint sink	Stainless wheel/ $\delta$ 1	1



## 10.8 Loudspeaker box assembly

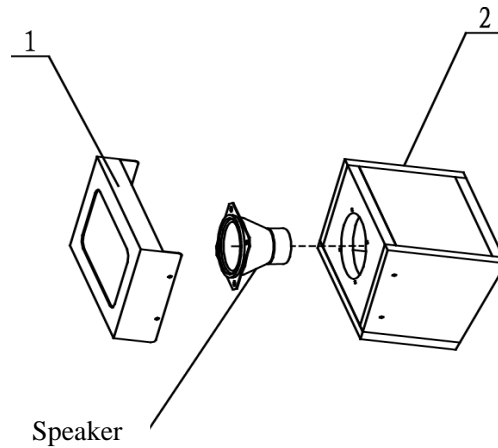

No.	Part No.	Code No.	Name	Material/Spec.	Qty
1	A105-162-000	20241207081	Box cover	Q235/ $\delta=1.5$ , Powder black	1
2	A105-004-000	29941207010	Box assembly	Assembly	1



## 10.9 L&R Fabric Curtain Assembly

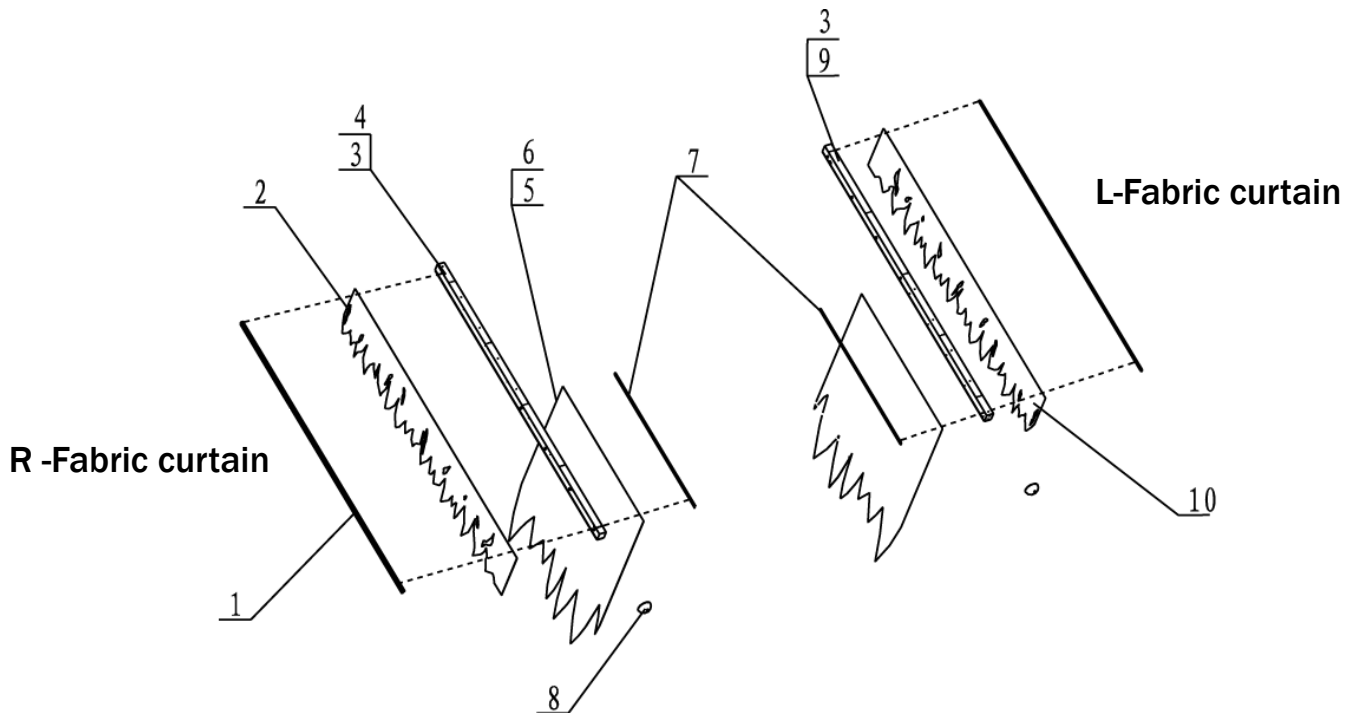

No.	Part No.	Code No.	Name	Material/Spec.	Qty
1	A105-163-000	20241207083	Side fabric pressure bar	Q235/ $\delta=1.5$ , Powder black	2
2	A105-436-000	20541207020	Green fabric R decal	0.3High precision waterproof cloth/2200*450	1
3	A105-616-000	20641207007	Cover board organic slice	Plastic/ $\delta=5$	2
4	A105-164-000	20241207091	R-side fabric bracket	Q235/ $\delta=2$ , Powder black	1
5	A105-437-000	20541207018	L&R dossal	0.3 cloth/1069*1206	2
6	A105-438-000	20641207005	Inside black fabric	Double black nylon fabric / $\delta=0.2$	2
7	A105-165-000	20241207082	Pressure inside fabric	Q235/ $\delta=1.5$ , Powder black	2
8	A105-439-000	20641207006	Repaired mouth piece	Nylon black/ $\Phi 90$	2
9	A105-166-000	20241207084	L-side fabric bracket	Q235/ $\delta=2$ , Powder black	1
10	A105-440-000	20541207021	Green fabric L decal	0.3High precision waterproof cloth/2200*450	1



### 10.10 Vibration Gun

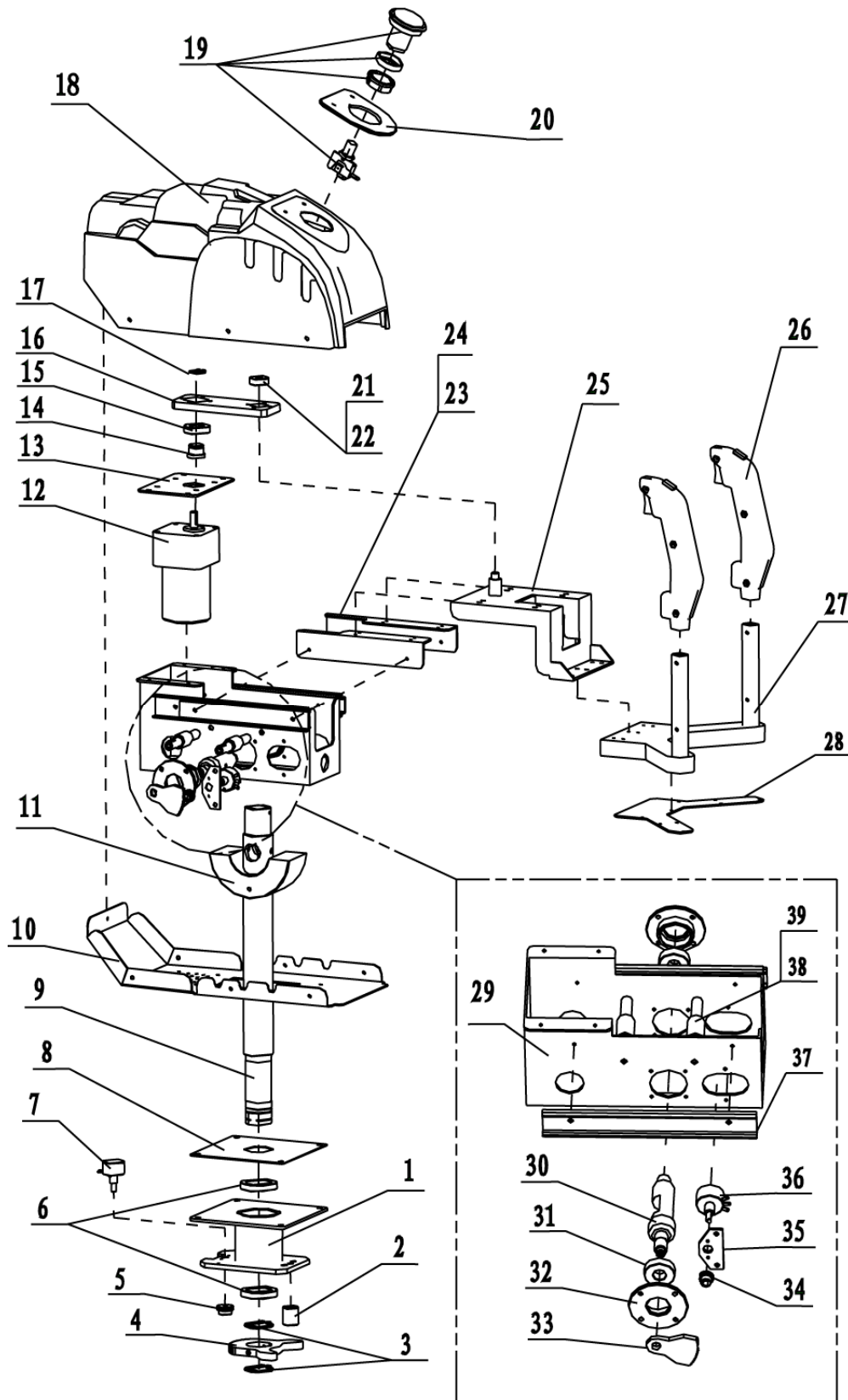



No.	Part No.	Code No.	Name	Material /Spec.	Qty
1	A105-167-000	20241123011	Engine base	Q235/ MF-Zn	1
2	A105-617-000	20641123001	Damping sleeve 1	Optimal force glue/transparent	1
3	A105-168-000	20105000024	A type Cir- clip	Q235/do30	2
4	A105-169-000	20241123018	Gear1	Q235/MF-Zn	1
5	A105-170-000	20241123019	Gear 2	45/MF-Zn	1
6	A105-200-000	20106000196	Deep groove ball bearing	61806-2Z	2
7	A105-441-000	22501000029	POT	5KPOT	2
8	A105-171-000	20241123010	Engine base panel	304/1.2( Sand panel )	1
9	A105-172-000	20241123012	Horizontal axis	seamless tubeΦ34x5.0/Pow der black	1
10	A105-173-000	20241123009	Bottom plate	Q235/1.5(Powder black)	1
11	A105-618-000	20241123022	Guide block	Nylon /black	1
12	A105-442-000	23404000024	PC motor	55ZY12-15-03/60 JB4G0832 DC12V 15W	1
13	A105-174-000	20241123002	Motor board	Q235/2.0(Powder black)	1
14	A105-175-000	20241123016	eccentric shaft	45/MF-Zn	1
15	A105-443-000	20106000066	Deep groove ball bearing	61903ZZ	1
16	A105-176-000	20241123017	Connect board	8x45/MF-Zn	1
17	A105-177-000	20105000035	A type cir clip	Q235/do17	1
18	A105-619-000	20641123003	Shell	ABS/3.0(black)	1
19	A105-444-000	22401030006	Button	With light/Micro SW	1
20	A105-620-000	20641123004	Button plate	Acrylic /3.0Transparent	1
21	A105-445-000	20106000013	Deep groove ball bearing	608	1
22	A105-178-000	20113000033	C level Pacific washer	Q235/Φ4.5×Φ12 ×1.0	1
23	A105-179-000	20241123004	R-sliding plate	Q235/2.0(Powder black)	1
24	A105-180-000	20241123003	L- sliding plate	Q235/2.0(Powder black)	1



No.	Part No.	Code No.	Name.	Material/Spec.	Qty
25	A105-181-000	20241123005	Jolting plate	Q235/2.0(Powder black)	1
26	A105-446-000	20841123001	Handle	Grey	2
27	A105-182-000	20241123006	Handle base	Q235/2.0(Powder black)	1
28	A105-183-000	20241123007	Handle cover	Q235/1.5(Powder black)	1
29	A105-184-000	20241123001	Motor bracket	Q235/2.0(Powder black)	1
30	A105-185-000	20241123013	Vertical axis	45/MF-Zn	1
31	A105-447-000	20106000083	Deep groove ball bearing	6001ZZ	2
32	A105-186-000	20241123014	Bearing base	45/MF-Zn	2
33	A105-187-000	20241123020	Gear 3	Q235/MF-Zn	1
34	A105-188-000	20241123021	Gear 4	45/MF-Zn	1
35	A105-189-000	20241123008	POT board	Q235/2.0(Powder black)	1
36	A105-448-000	22501000029	POT	5KPOT	
37	A105-449-000	25105000007	Guide rail	/27×195	2
38	A105-190-000	20241123015	Limit shaft	45/MF-Zn	2
39	A105-621-000	20641123002	Damping sleeve2	Optimal force glue/transparent	2



### 10.11 Electrical Parts

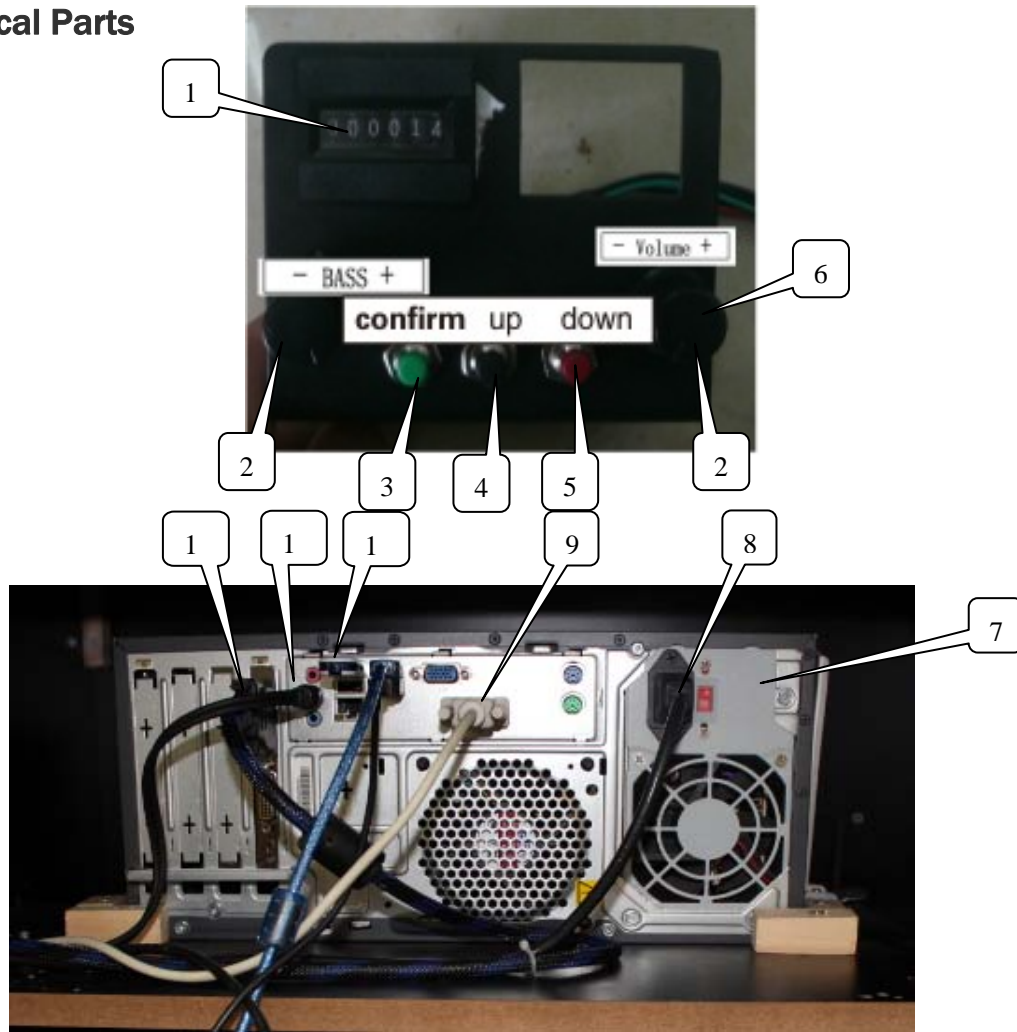

No.	Part No.	Code No.	Name	Material/Spec.	Qty
1	A105-450-000	23000000006	Counter	C-012 12VDC 18CPS	1
2	A105-451-000	22501000033	POT	RB50K Duplex	2
3	A105-452-000	22402030002	Button	PB:11C02R(green)	1
4	A105-453-000	22402050001	Button	PB:11C02R(black)	1
5	A105-454-000	22402010002	Button	PB:11C02R(red)	1
6	A105-455-000	21709000002	POT board	VR.PCB	2
7	A105-456-000	21100000026	Lenovo computer	Lenovo M7300	1
8	A105-457-000	23301050002	Power cable	Pin-3×0.75mm 0.5m	4
9	A105-458-000	21404000053	Serial port socket	L type- DB9F	1
10	A105-459-000	20841207007	Dongle	Dongle	1
11	A105-460-000	21404000015	Audio line plug	3.5mmStereo headset plug	1
12	A105-461-000	23307020001	DVI-DVI video plug	DVI-DVI(3m)	1

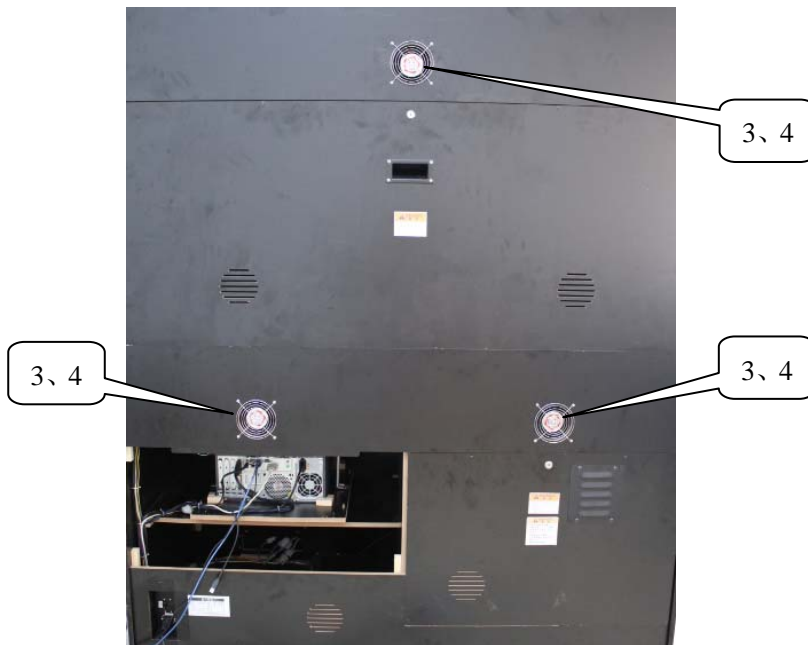
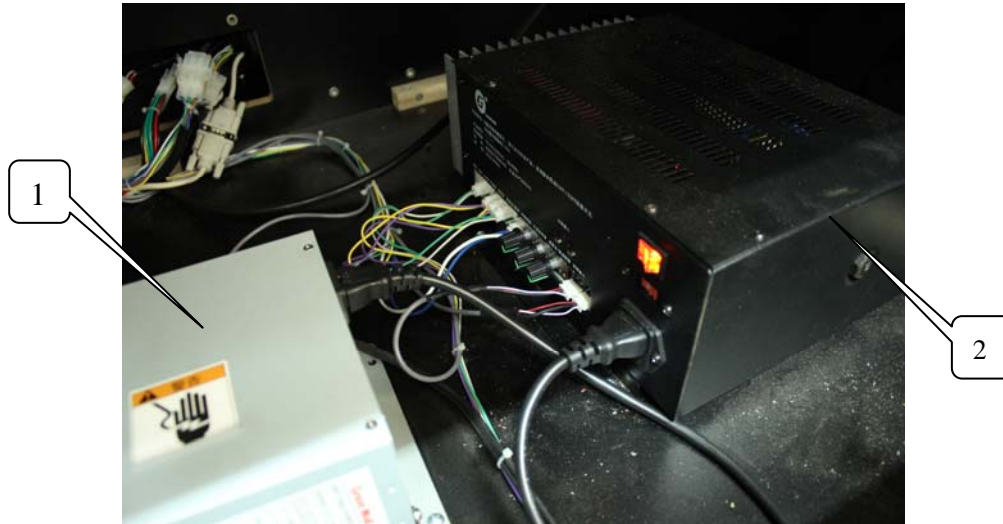

No.	Part No.	Part No.	Name	Material/Spec.	Qty
1	A105-462-000	21602000001	Power box	BTX-3039(110V220V)	1
2	A105-463-000	22803000041	5.1 Channel power amplifier	Gc-518	1
3	A105-464-000	22702000010	Fan net	4'	7
4	A105-465-000	22702000002	Fan	4'220V	4

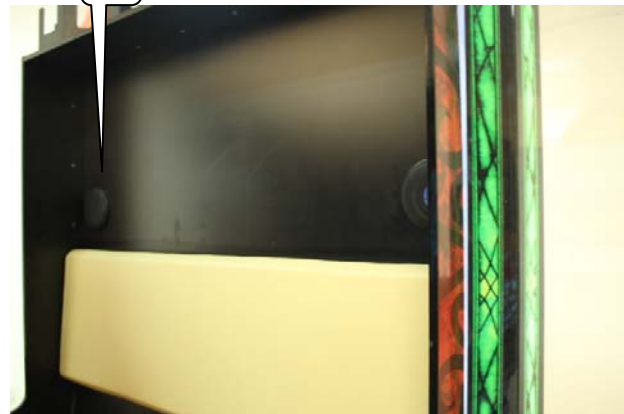
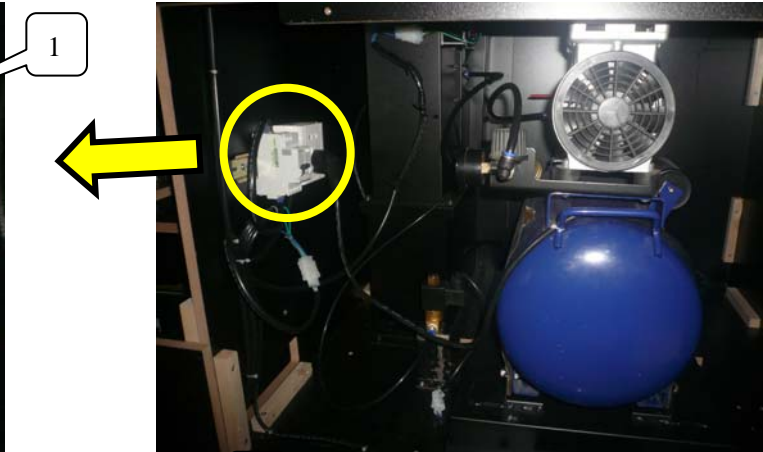

No.	Part No.	Code No.	Name	Material/Spec.	Qty
1	A105-466-000	21606000010	Consent	TCL-K4.0 KG426/10USU	1
2	A105-467-000	22601000086	leakage switch	Milan leakage switch 16A	1
3	A105-468-000	22801000010	Alt speaker	4'4Ω25W	4
4	A105-469-000	21201055002	55'LCD bare machine	55'LCD HDMI connector	1

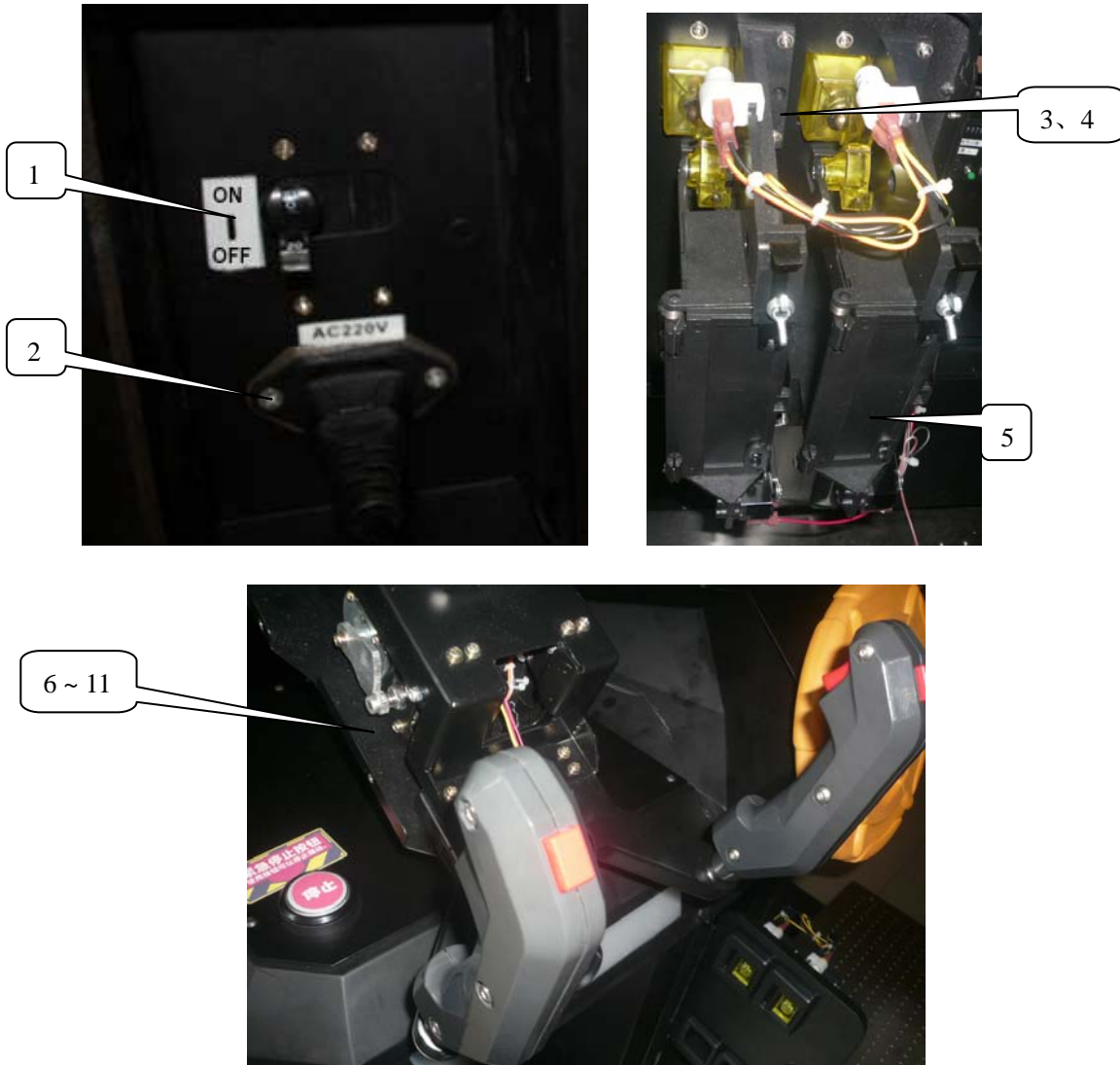

No.	Part No.	Code No.	Name	Material/Spec.	Qty
1	A105-470-000	22601000076	Cut-out switch	8340-F120 20A	1
2	A105-471-000	23201000001	Filter	YB10A1 10A/250V	1
3	A105-472-000	22003000006	LED plug bubble	LED(12V) bulbJA-T810	5
4	A105-473-000	22201000028	12Vwhite light socket	socket-for coin Mech.	1
5	A105-474-000	22301000007	Electronic coin Mech.	TW-800 II	1
6	A105-475-000	21501000043	Infrared	SHARP 0A41SK F 1Y	4
7	A105-476-000	22604000006	Micro switch	BLM-S 3A-125/250VAC	5
8	A105-477-000	22401030006	Medium turning belt lamp button	New white	4
9	A105-478-000	22501000029	5K POT	RV24YN 20F B502	5
10	A105-479-000	21903000004	Recoverable insurance tube	GF300	2
11	A105-480-000	22604000011	Micro switch	SM short ZIPPY5A 125-250VAC	8

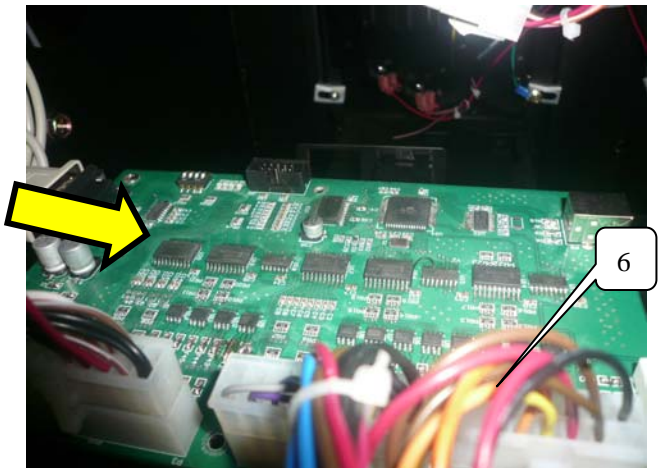
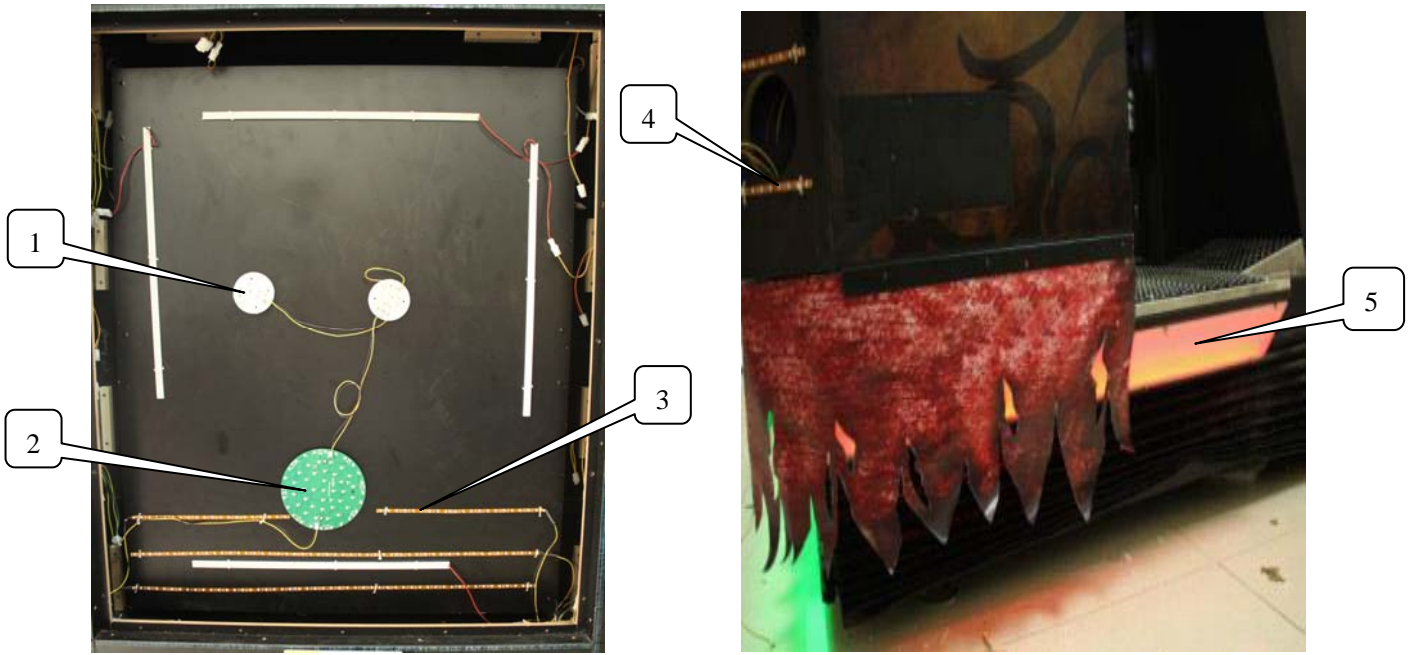

No.	Part No.	Code No.	Name	Material/Spec.	Qty
1	A105-481-000	29740803017	PCB board	HHXYS-LED01.PCB (V1.0)	2
2	A105-482-000	29710805013	PCB board	CLGW-LED3.PCB(V1.0)	1
3	A105-483-000	22002013003	LED flexible light belt	DC12V 3528LED White LED	7.2
4	A105-484-000	22002013009	LED flexible light belt	DC12V 3528LED 60 /m Green	12.5
5	A105-485-000	22002013006	LED flexible light belt	DC12V 3528LED 60 /m red	7.1
6	A105-486-000	29740803017	PCB board		1



### 10.12 Decals

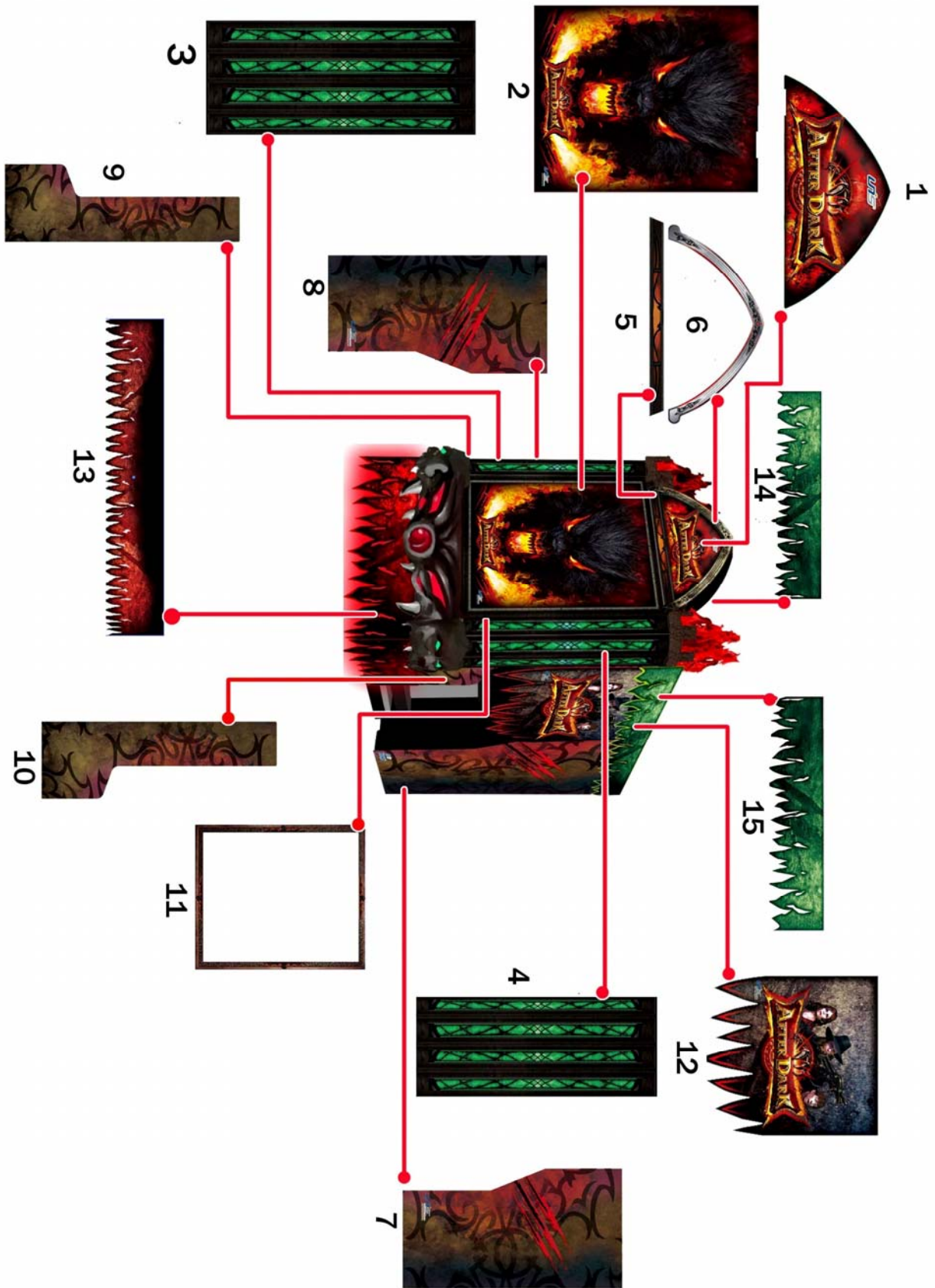



No.	Part No.	Code No.	Name	Material/Spec.	Qty
1	A105-701-000	20541207C001	Marquee up decal	803×368/δ3Transparent slice	1
2	A105-702-000	20541207C002	Middle marquee decal	959×1152/δ5Transparent slice	1
3	A105-703-000	20541207003	Lamp standard R-decal	578×1318/δ5Transparent slice	1
4	A105-704-000	20541207004	Lamp standard L-decal	578×1318/δ5Transparent slice	1
5	A105-705-000	20541207005	Sidelight decal	916×65/white PVC	1
6	A105-706-000	20541207006	Light Semicircle decal	1075×519/white PVC	1
7	A105-707-000	20541207C007	R-side decal(big)	1251×2083/white PVC	1
8	A105-708-000	20541207C008	L-side decal(big)	1251×2083/white PVC	1
9	A105-709-000	20541207009	Seat L-decal	520×1573/white PVC	1
10	A105-710-000	20541207010	Seat R-decal	520×1573/white PVC	1
11	A105-711-000	20541207011	Frame decal	1075×1260/white PVC	1
12	A105-712-000	20541207C018	Two sides decal	1069×1206/0.3 Gibb	1
13	A105-713-000	20541207019	Back seat dossal	2590×330/0.3High precision waterproof cloth	1
14	A105-714-000	20541207020	Green fabric R-decal	2200×450/0.3High precision waterproof cloth	1
15	A105-715-000	20541207021	Green fabric L-decal	2200×450/0.3High precision waterproof cloth	1

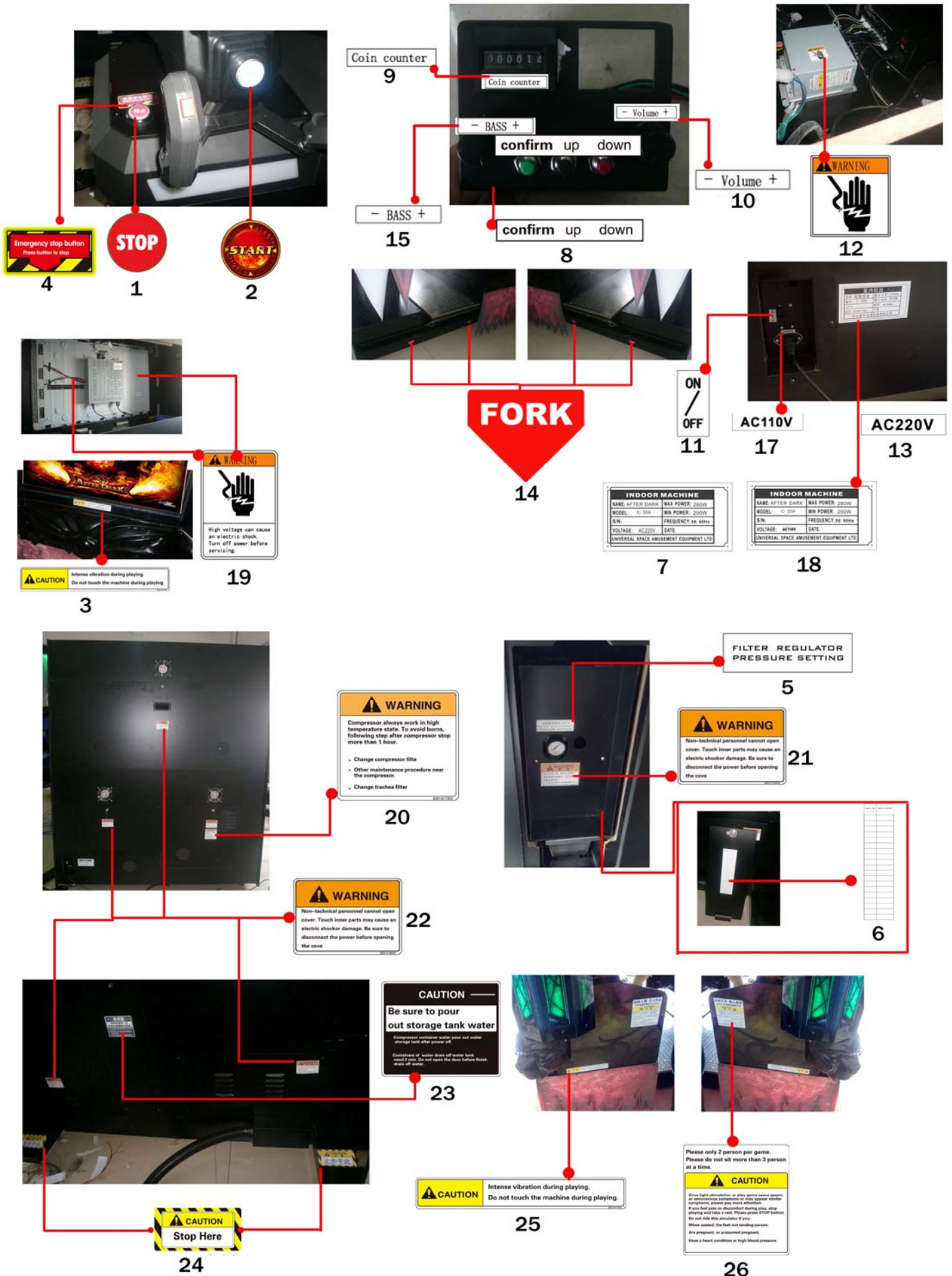



No.	Part No.	Code No.	Name	Material/Spec.	Qty
1	A105-716-000	20541207C012	Stop button	33×33/white PVC	2
2	A105-717-000	20541207C013	Start button	33×33/white PVC	2
3	A105-718-000	20541207C014	Warning label	390×486/white PVC	1
4	A105-719-000	20541207C015	Emergency stop decal	74×39/white PVC	2
5	A105-720-000	20541207C016	Filtering gate inside pressure label	79X25white PVC	1
6	A105-721-000	20541207C017	Filter door back decal	280X70	1
7	A105-722-000	20541207C022	Un-authentication 220v nameplate	128×68 1cm PVC	1
8	A105-723-000	20541207C023	Affirm label	49×60/white PVC	1
9	A105-724-000	25600000001	Coin counter	30×6/white PVC	1
10	A105-725-000	25600000003	Volume label	30×6/white PVC	1
11	A105-726-000	25600000016	Power SW label A	12×25/white PVC	1
12	A105-727-000	25600000036	High pressure warning (small)	41×42/white PVC	3
13	A105-728-000	25600000041	Label 220V	25×6/white PVC	1
14	A105-729-000	25600000035	Fork label	50×40/white PVC	4
15	A105-730-000	25600000004	Low sound label	22×6/white PVC	1
16	A105-731-000	25600000054	Watch Your Hands label	20×22/white PVC	2
17	A105-732-000	25600000040	Label 110V	25×6/white PVC	1
18	A105-733-000	20541207C024	Un-authentication 110v nameplate	128×68 1cm PVC	1
19	A105-734-000	25600000036	High pressure warning (small)	41×42/white PVC	3
20	A105-735-000	20541207C014	Warning label	390×486/white PVC	1
21	A105-736-000	20541207C014	Warning label	390×486/white PVC	1
22	A105-737-000	20541207C014	Warning label	390×486/white PVC	1
23	A105-738-000	20541207C014	Warning label	390×486/white PVC	1
24	A105-739-000	20541207C014	Warning label	390×486/white PVC	1
25	A105-740-000	20541207C014	Warning label	390×486/white PVC	1
26	A105-741-000	20541207C014	Warning label	390×486/white PVC	1

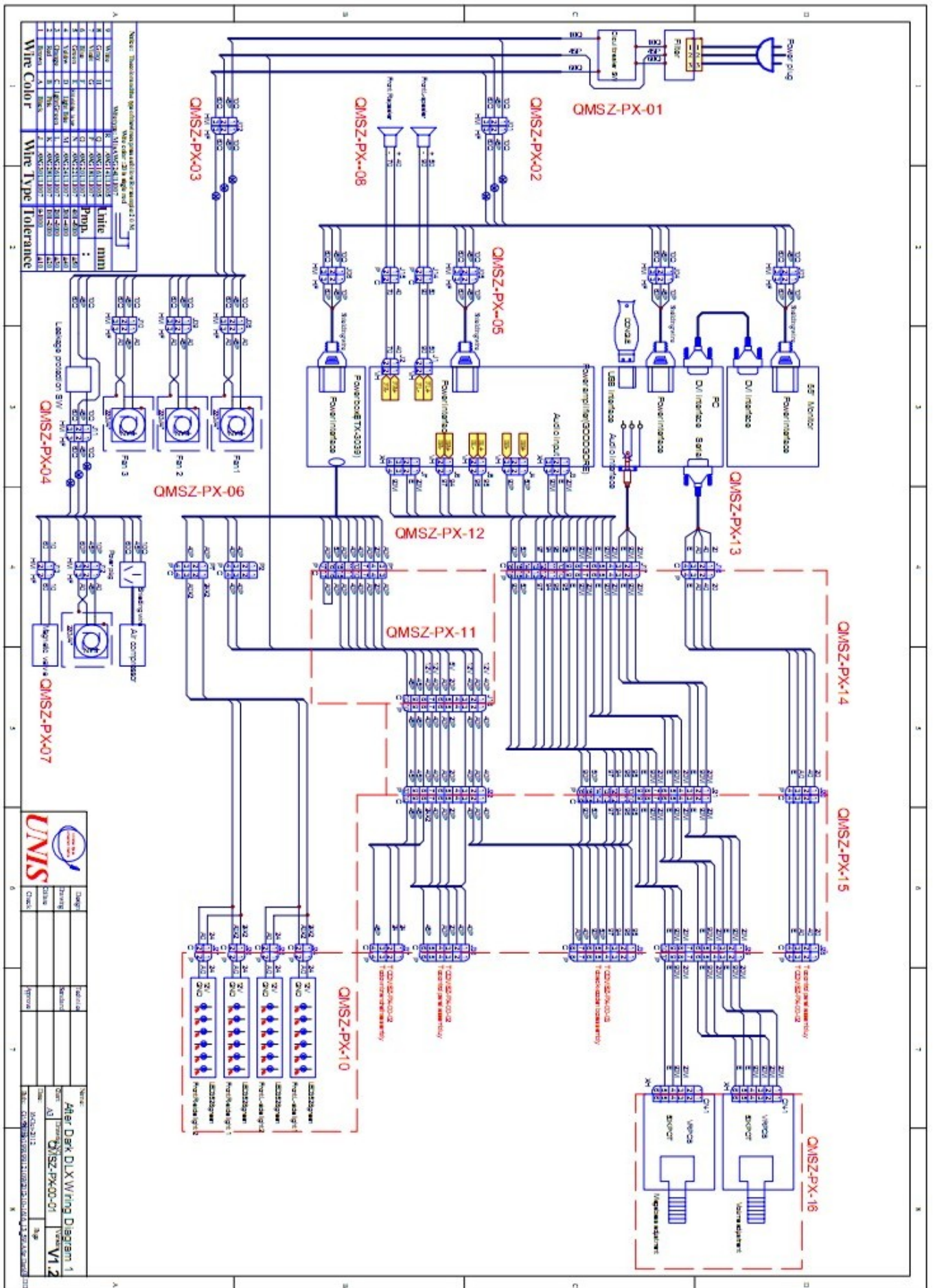



**Have Questions? Contact us!**

[www.zs-shiyu.com](http://www.zs-shiyu.com)

[www.universal-space.com](http://www.universal-space.com)

**Canada Office Parts & Service**

**+1-905-477-2823**

Email: [service@universal-space.com](mailto:service@universal-space.com)