

PLEASE READ THIS PAGE AND THE OWNER'S MANUAL
BEFORE USING THIS MACHINE!!

1. IN OUR EFFORTS TO CONTINUALLY IMPROVE OUR MACHINE, WE MAKE CHANGES WHICH SOMETIMES CONFUSE OWNERS OF EARLIER MODELS. WE ARE COMMITTED TO MAKING THIS MACHINE AS DURABLE, AS EASY, AS FAST, AND AS SAFE TO USE AS IS HUMANLY POSSIBLE. YOUR MACHINE CONTAINS THE FOLLOWING CHANGES:
 - A. WE SHORTENED THE LENGTH OF THE CHEESE PLUNGER FOR SEVERAL REASONS. ON OCCASION WHEN THE MACHINE IS ASSEMBLED FOR USE, THE SLIDER RODS ARE NOT TIGHTENED AND AS A RESULT, THE CHEESE PLUNGER ROCKS AND HITS THE BLADES, PUTTING PLASTIC IN YOUR CHEESE. WE ALSO DOUBLED THE LENGTH THE THREADS AT THE BOTTOM OF THE SLIDER RODS.
THE VERTICAL WALLS OF OUR HOPPER LID OPENING EXCEED THE INTERNATIONAL SAFETY STANDARDS OF 12 CENTIMETERS. OUR HOPPER OPENING IS LARGER THAN MOST OTHER MACHINES AND PROVIDE EASIER ACCESS. AS YOU LIFT THE PLUNGER TO PUT THE NEXT PIECE OF CHEESE INTO OUR MACHINE, THE BLADE IS EXPOSED. SHORTENING THE PLUNGER RESULTS IN LEAVING A PIECE OF CHEESE IN THE HOPPER ABOUT 1-1/2" THICK, BLOCKING ACCESS TO THE BLADE. PUTTING THE NEXT PIECE OF CHEESE ON TOP OF THE LEFTOVER PIECE OF CHEESE RESULTS IN A SMOOTHER PROCESSING OF THE SMALL LEFTOVER PIECE OF CHEESE. AT THE END OF YOUR SHREDDING SESSION, YOU WILL END UP WITH 1 PIECE OF CHEESE WHICH CAN BE WRAPPED UP AND STORED IN THE REFRIGERATOR UNTIL NEXT SHREDDING SESSION SO NOTHING IS WASTED.
 - B. SHARP BLADES WORK BETTER THAN DULL BLADES. THIS IS ALSO TRUE FOR OUR BLADES. WE BUY THE BEST BLADES WE CAN FIND FOR OUR MACHINE. THEY ARE MADE FROM HIGHEST QUALITY STAINLESS STEEL AND ARE VERY SHARP WHEN THEY ARRIVE WITH YOUR MACHINE. BECAUSE OUR BLADES ARE MADE FROM THICKER METAL, THEY LAST LONGER AND THUS NEED TO BE RESHARPENED FROM TIME TO TIME. PURCHASE A 3/16" CHAIN SAW FILE AND A FILE HANDLE. PLACE YOUR BLADE UPSIDE DOWN ON A TOWEL, ALLOWING THE BLADE TO OVERHANG THE EDGE OF YOUR TABLE. PLACE THE FILE THROUGH THE HOLE OF A TOOTH AT ABOUT A 45 DEGREE ANGLE. RUN THE FILE BACK AND FORTH ABOUT 5 OR 6 TIME ACROSS THE LEADING EDGE OF THE INSIDE OF THE TOOTH DIMPLE. THIS PUTS A SHARP CUTTING EDGE BACK ON THE TOOTH. DO THIS ON EACH TOOTH. SHARPENING THE BLADE SHOULD TAKE LESS THAN 10 MINUTES.

GS-1 OWNERS MANUAL

2. TABLE OF CONTENTS
3. SHIPPING DAMAGE INSTRUCTIONS
4. SAFETY INSTRUCTIONS
5. SETTING UP THE MACHINE
6. ASSEMBLY DIAGRAM
7. BLADE HOLDER ALIGNMENT INSTRUCTIONS
8. RUNNING THE MACHINE, CLEANING THE MACHINE,
MACHINE MAINTENANCE
9. MACHINE WARRANTY
10. MACHINE PARTS LIST
11. FRONT END AND PLUNGER ARM ASSEMBLY PARTS DRAWING
12. MOTOR HOUSING PARTS DRAWING
13. MECHANICAL PARTS DRAWING
14. REPLACING THE BELT
15. ELECTRIC WIRING DIAGRAMS
16. ELECTRICAL TROUBLE SHOOTING INSTRUCTIONS

**PALAZZOLO MFG. CO.
743 BARG SALT RUN ROAD
CINCINNATI, OHIO 45244
PHONE ; 513-528-7016
FAX : 513-528-2745**

SHIPPING DAMAGE INSTRUCTIONS

PLEASE INSPECT THE CONTENTS OF THIS PACKAGE. THIS SHIPMENT IS INSURED AGAINST DAMAGE CAUSED BY MISHANDLING BY YRC CORP PERSONNEL. IF THERE IS ANY DAMAGE TO THE MACHINE, YOU MUST DO THE FOLLOWING:

1. CONTACT YRC CORP. AT:
1-800-610-6500 TO REPORT A DAMAGED SHIPMENT.
2. CALL PALAZZOLO MANUFACTURING CO. AT:
1-800-513-6333 AND NOTIFY US OF THE DAMAGE.
3. SAVE THE SHIPPING CONTAINER AND ALL THE INTERNAL PACKAGING PARTS THE MACHINE WAS PACKED IN FOR YRC CORP INSPECTORS.

IF THE ABOVE PROCEDURES ARE NOT FOLLOWED,
PALAZZOLO MANUFACTURING WILL NOT REPLACE
OR REIMBURSE YOU FOR PARTS DAMAGED DURING
SHIPMENT OF YOUR MACHINE.

SAFETY INSTRUCTIONS

MAKE SURE THAT EVERYONE IN YOUR STORE WHO WILL BE OPERATING THIS MACHINE WILL READ AND UNDERSTAND THIS MANUAL. PERSONS OPERATING THIS MACHINE MUST BE 18 YEARS OLD.

1. NEVER put hands or fingers inside the hopper opening while the machine is running.
2. NEVER start the machine unless it is fully assembled including the Hopper Lid and the black knobs are tightly locked down.
3. NEVER plug the machine into an electrical outlet that is not properly wired or fused. The motor and switches will be damaged and void the warranty on those parts. Check the nameplate at the rear of the machine for electrical information.
4. NEVER use an extension cord that is not rated for your motor load. Wire gauge for an extension chord should be 12 gauge or heavier. Failure to use a proper extension chord will cause early motor burnout and voids the motor warranty.
5. NEVER use blades from other manufacturers. Though the diameter and bolt pattern may be similar, our blades have teeth all the way to the center of the blade.
6. ALWAYS make sure that the Slider Rods are tightened before using the machine.
7. ALWAYS unplug the machine before performing any maintenance or repairs.

SETTING UP THE MACHINE (refer to drawing 1–page 6

As you unpack the machine, you will notice that all the front end parts which come off for cleaning are not attached and are packed in the smaller box.

1. REFER TO DRAWING 1 ON PAGE 6, Place the motor housing on the table and install the Ram Arm Assembly to the rear panel, securing the Ram Arm Assembly using the two 5/16" bolts and three flat washers. Start the bottom bolt first, then start the top bolt and then tighten bolts.
2. Install the Chute onto the 2 bolt heads protruding from the left and right sides near the front of the Motor Housing.
3. Install the Lower Housing, the Blade Holder, (making sure that the Blade Holder is properly aligned on the hub per drawing on page 7), the Blade, and the Hopper Lid. Screw the plastic knobs onto the bolts on each side of the Motor Housing and swivel the bolts with knobs up into the slots of the Hopper Lid and tighten knobs securely. Install the Chute Cover onto the Chute.
4. Screw the 2 slider rods tightly into the 2 coupling nuts located on either side of the Hopper Lid opening. Put the end on the Ram Arm through the hole in the Plunger and slide the Plunger down over the 2 Slider Rods.
5. Insert the plug on the electric cord into a properly wired outlet. See chart below:
below.

ELECTRICAL OUTLET REQUIREMENTS:

(Check label on Rear Panel for h.p. and voltage ratings.)

MOTOR	VOLTS	PHASE	OUTLET
1-1/2 H.P.	115	1	NEMA 5-20R
2 H.P.	230	1	NEMA 6-15R
2 H.P.	208/230	3	PLUG NOT FURNISHED
3 H.P.	208/230	3	PLUG NOT FURNISHED
5 H.P.	208/230	3	PLUG NOT FURNISHED

WIRING PLUGS FOR 3 PHASE MOTORS: L1=RED, L2=WHITE, L3=BLACK, GROUND=GREEN.

TRANSMISSION SHAFT ROTATION : CCW NOTE: Due to the wide variety of outlets and plugs for 3 phase, ETL requires that we do not include a plug with our machines with 3 phase motors to avoid any confusion.

DRAWING 1

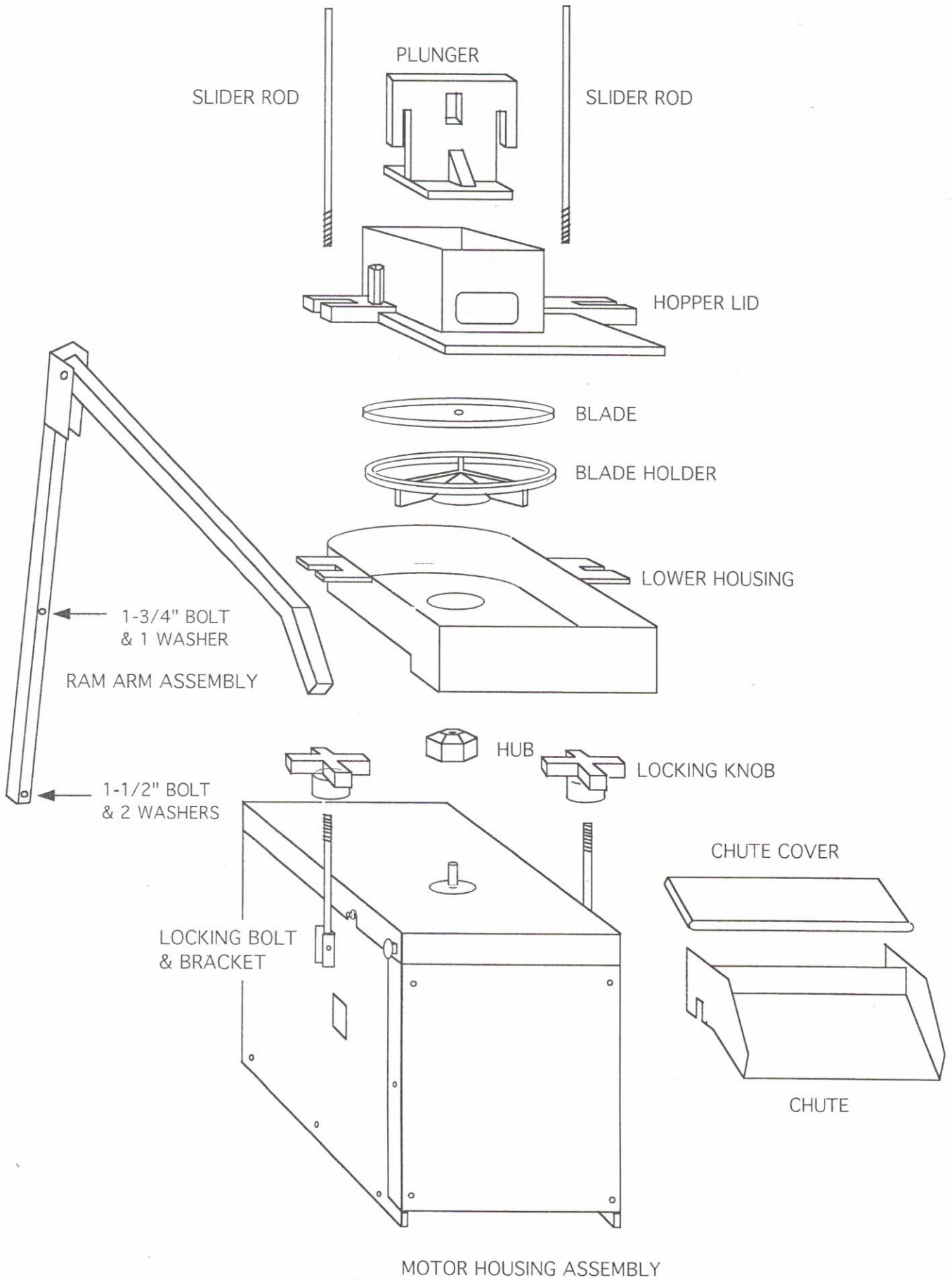

IMPORTANT:

FOR ALL PERSONS USING THIS MACHINE

WHEN YOU PLACE THE BLADE HOLDER ONTO THE HUB, LOOK ON THE UNDERSIDE OF THE BLADE HOLDER FOR THE 1/4" HOLE. THIS HOLE MUST BE LINED UP WITH THE KEYWAY ON THE TOP OF THE HUB. IF YOU DON'T FOLLOW THIS PROCEDURE, YOU WILL HAVE TROUBLE REMOVING THE ROTOR DURING CLEAN-UP.

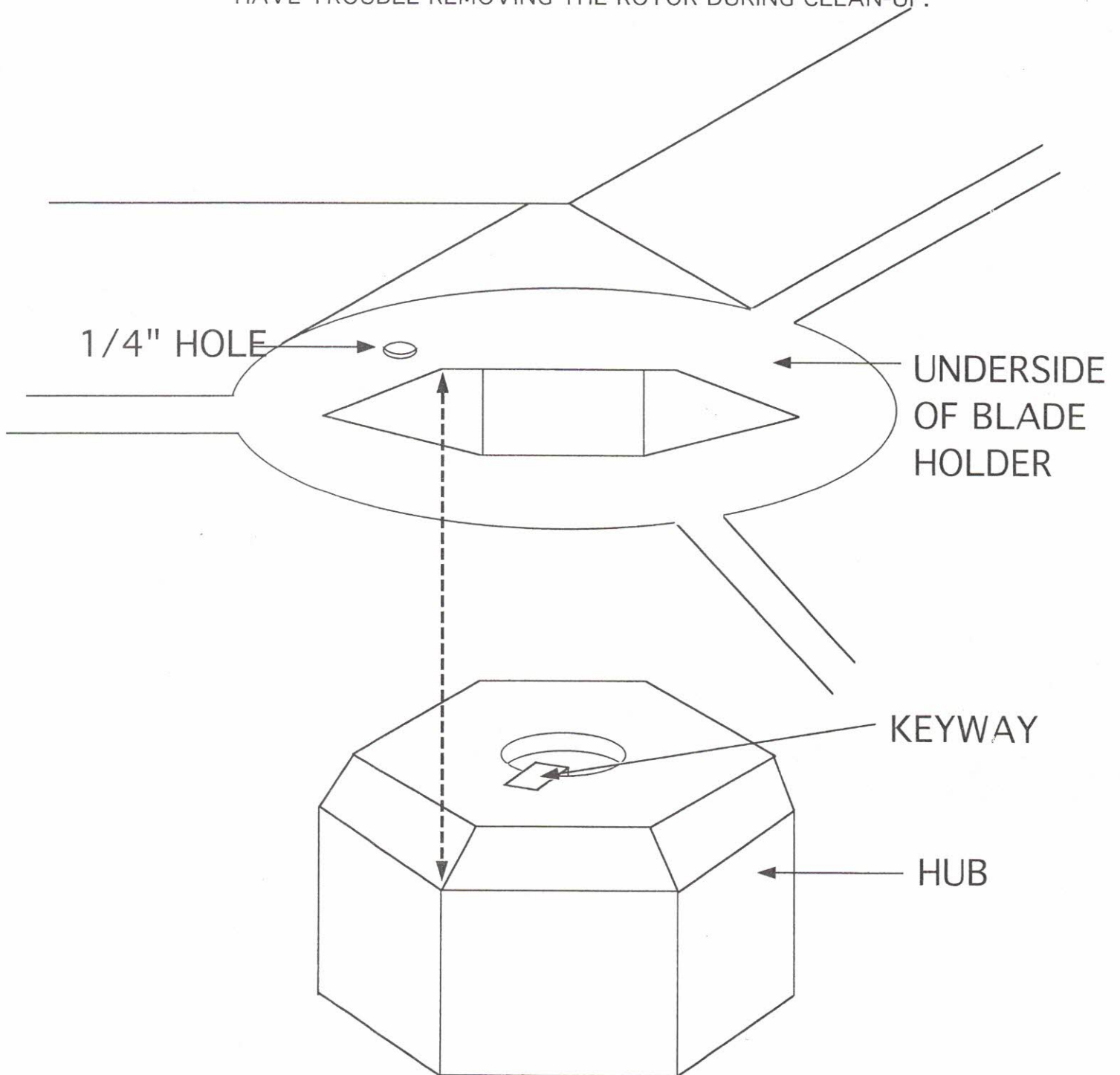

RUNNING THE MACHINE

1. Unwrap your 6 pound blocks of cheese and set them on the table next to the machine. **DO NOT SHRED FROZEN CHEESE.** If the room temperature is warm, do not let the cheese sit out and warm up. The cheese will sweat and become **sticky.**
2. Make sure you place a large container under the Chute to catch your cheese.

NEVER START THE MACHINE WHEN IT IS CLEAN.

3. Place the first block of cheese upright into the Hopper opening and lower the Plunger to the top of the cheese, maintaining moderate pressure.
4. Turn the GS-1 machine switch to the "on" position and then pull down on the Ram Arm.
5. Raise the Ram Arm, place another block of cheese upright into the Hopper opening and lower the Plunger until it makes contact with the cheese, remove your hand. Leave the GS-1 machine running. Continue this procedure until your cheese is shredded. If you need to stop for any reason, turn the GS-1 Machine off. When you are finished for the day, turn the switch to the "off" position. Wrap the leftover piece of cheese in a piece of plastic wrap and refrigerate. Disassemble the machine for cleaning.

CLEANING THE MACHINE

When you finish shredding your cheese, loosen the 2 locking knobs and remove the Plunger, the Hopper Lid, the Blade, the Blade Holder, the Lower Housing, the Chute Cover and the Chute from the Motor Housing. All of these parts can be washed in a dishwashing machine or by hand. Do not leave the aluminum casting sitting in detergent water for long periods. They may discolor with some detergents. Wipe the Motor Housing down with a wet cloth and then dry the housing with a dry towel.

MAINTENANCE:

The motors have ball bearing construction. Only the 3 h.p. and the 5 h.p. motors require lubrication. The 2 ball bearings on the jack shaft have sealed bearing and don't need lubrication. At some point way down the road, there is a special rubber belt on the gearpulleys that will need to be replaced. The belt can be purchased from W.W. Grainger Inc. The part number can be found on page 13.

LIMITED

Palazzolo Manufacturing warrants this machine to the original purchaser against defects in material and workmanship under normal use for 180 days on electrical switches, and air components, and two years from the date of purchase on all other parts except for the motor and blades. Any part covered by our warranty which is determined to be defective in materials or workmanship and is returned freight prepaid, will be repaired or replaced at Palazzolo Manufacturing's option.

The Baldor Electric Co. warrants the replacement or repair of the motor for one year from date of shipment. Labor charges to diagnose a warranty related problem and to repair a motor will be covered. Labor charges to remove and replace the motor from your machine is not covered by Baldor Electric Co. or Palazzolo Mfg. Co.

The Worldwide Electric Co. warrants the replacement of the motor for two years from the date of shipment. Customer will remove the aluminum motor plate from the defective motor and mail it to Palazzolo Mfg. Co. If this is not done, the customer will be required to pay for the new motor. Labor charges to remove or replace the motor from your machine is not covered by Baldor Electric Co. or Palazzolo Mfg. Co.

LIMITS OF LIABILITY: To the extent allowable under applicable law, Palazzolo Manufacturing's liability for consequential or incidental damages is expressly disclaimed. Palazzolo Manufacturing's liability in all events is limited to, and shall not exceed the purchase price paid.

DISCLAIMER: Palazzolo Manufacturing has made a diligent effort to describe the product herein however such descriptions are for the sole purpose of identification and do not express or imply a warranty that the product is merchantable or fit for a particular purpose, or that the product will necessarily conform to the descriptions. No warranty or affirmation of fact, expressed or implied, other than stated in "LIMITED WARRANTY" above is made or authorized by Palazzolo Manufacturing Co. and Palazzolo Manufacturing Co.'s liability in all events is limited to the purchase price paid.

PROMPT DISPOSITION: Palazzolo Manufacturing will make a good faith effort for prompt correction or other adjustment with respect to this product which proves to be defective within warranty. For any product believed to be defective within the warranty period, call Palazzolo Manufacturing at 513-528-7016.

DAMAGE DURING SHIPPING: If the product was damaged in shipment to you, you must file a damage report with the shipping company. All shipments of our machines or parts are insured by the shipping company. Please notify Palazzolo Mfg. Co. immediately about a damaged shipment.

MODEL GS-1 PARTS LIST

FRONT END/RAM ARM PARTS – PAGE 11

1. 1 HOPPER LID
2. 1 BLADE
3. 1 BLADE HOLDER
4. 1 LOWER HOUSING
5. 1 CHUTE & COVER
6. 1 RAM ARM ASSEMBLY
7. 1 REAR ARM HARDWARE PACKET*
8. 2 END PLUGS*
9. 1 PLUNGER
10. 2 SLIDER RODS

MOTOR HOUSING PARTS – PAGE 12

11. 1 S/S TOP COVER
12. 1 S/S LEFT SIDE PANEL
13. 1 S/S RIGHT SIDE PANEL
14. 1 S/S FRONT PANEL
15. 1 RUBBER SEAL & S/S COVER PLATE
16. 1 GEARPULLEY PAN
17. 1 FRONT BRACE
18. 1 MACHINE BASE
19. 2 LOCKING BRACKET, BOLT, & KNOB
20. 1 CORD SET*
21. 1 HUB FOR ROTOR
22. 2 PLASTIC RUNNERS
23. 1 PAN SUPPORT

MECHANICAL COMPONENTS- PAGE 13

23. 1 1" X 33 TOOTH GEARBELT
24. 1 14 TEETH GEARPULLEY
25. 1 22 TEETH GEARPULLEY
26. 1 40 TEETH GEARPULLEY
27. 1 JACKSHAFT
28. 1 1" FLANGE BEARING
29. 1 3/4" FLANGE BEARING
30. 1 CONTACTOR SWITCH
31. 1 MOTOR
32. 1 SPACER

FRONT END - RAM /ARM PARTS

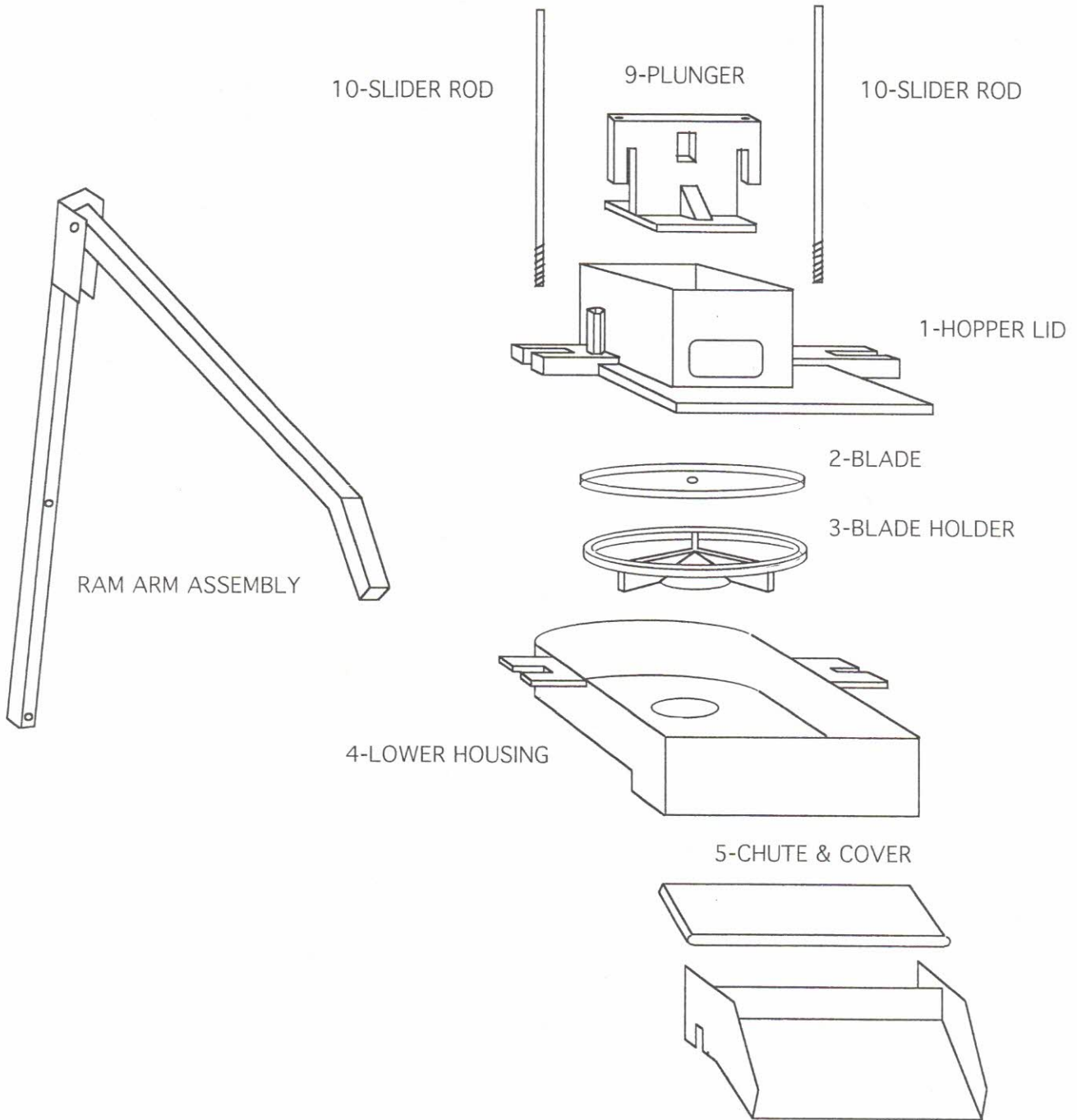

MOTOR HOUSING PARTS



21-HUB



15-GASKET PLATE
& RUBBER SEAL



19-LOCKING BRACKET,
BOLT, & KNOB

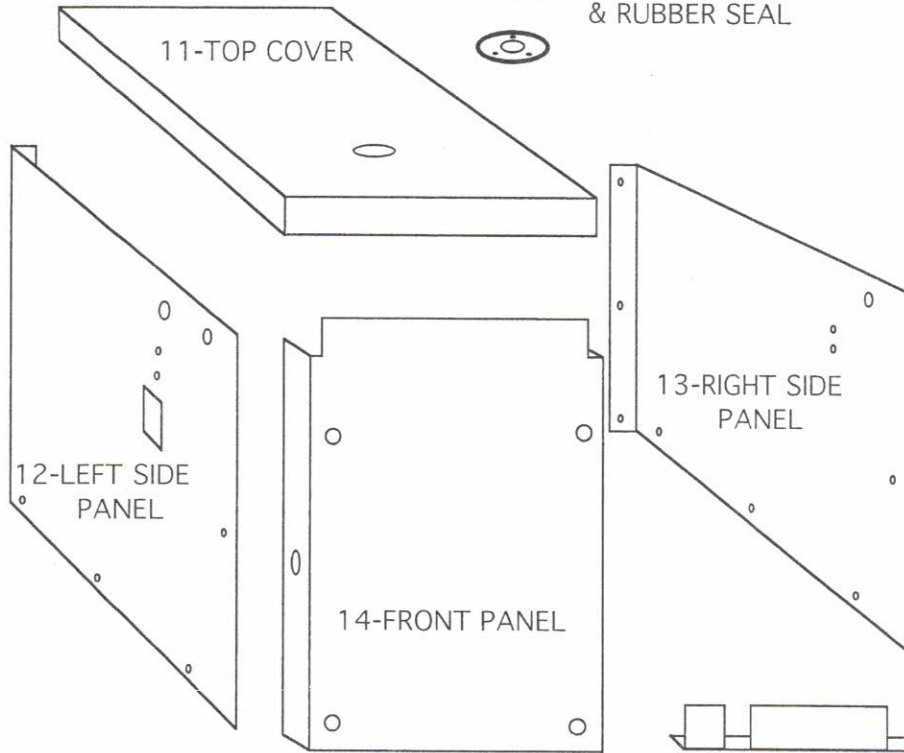

19-LOCKING BRACKET,
BOLT, & KNOB



23-PAN SUPPORT

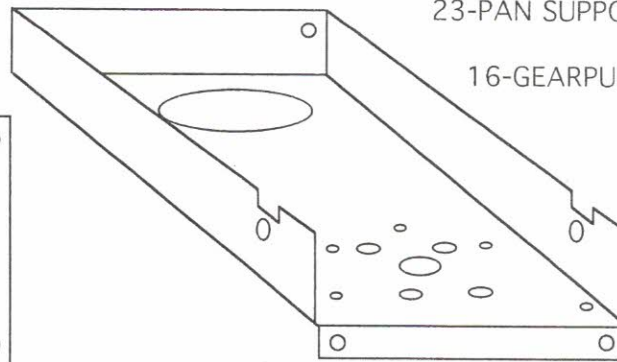

16-GEARPULLEY PAN

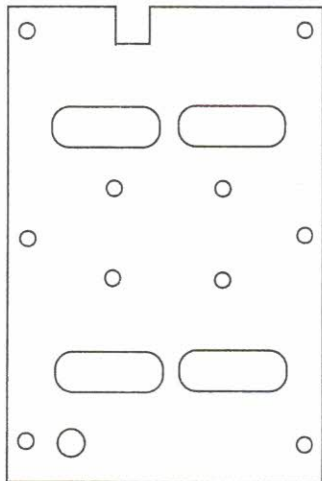

22-PLASTIC
RUNNER

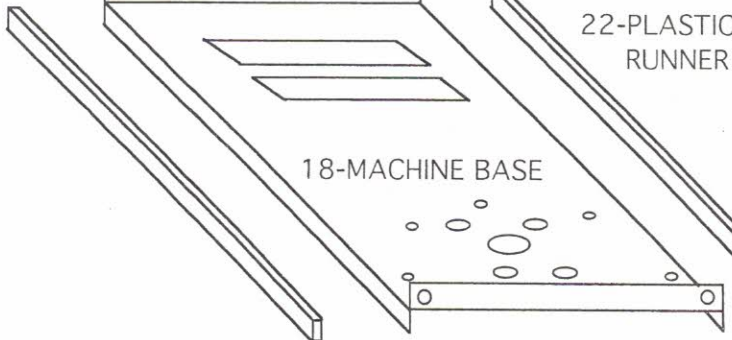

18-MACHINE BASE

22-PLASTIC
RUNNER

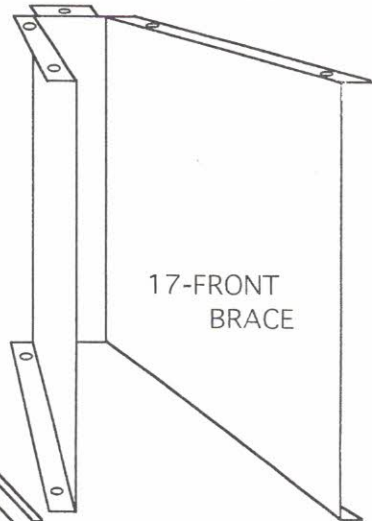

17-FRONT
BRACE

MECHANICAL COMPONENTS

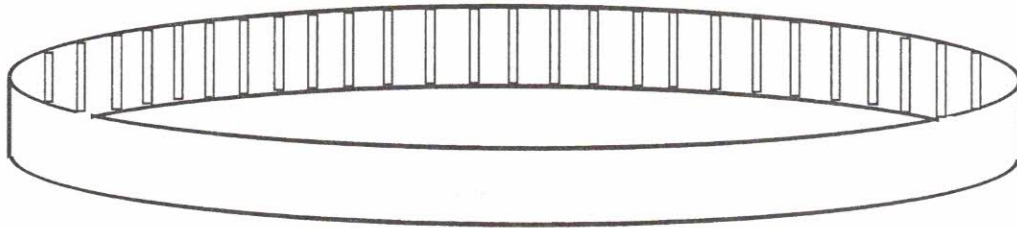

23.- 1" GEARBELT - 1DHT2 - W.W. GRAINGER



24.- P14H100-1108-14 TEETH

25.- P22H100-1610-22 TEETH
BALDOR

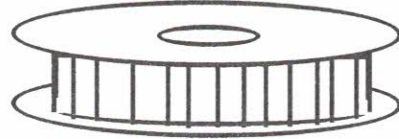

26.- P40H150-2517
40 TEETH
BALDOR



32 - SPACER
PALAZZOLO MFG CO

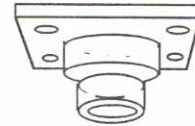

28.- 1" BEARING
W.W. GRAINGER
1F546 PART #

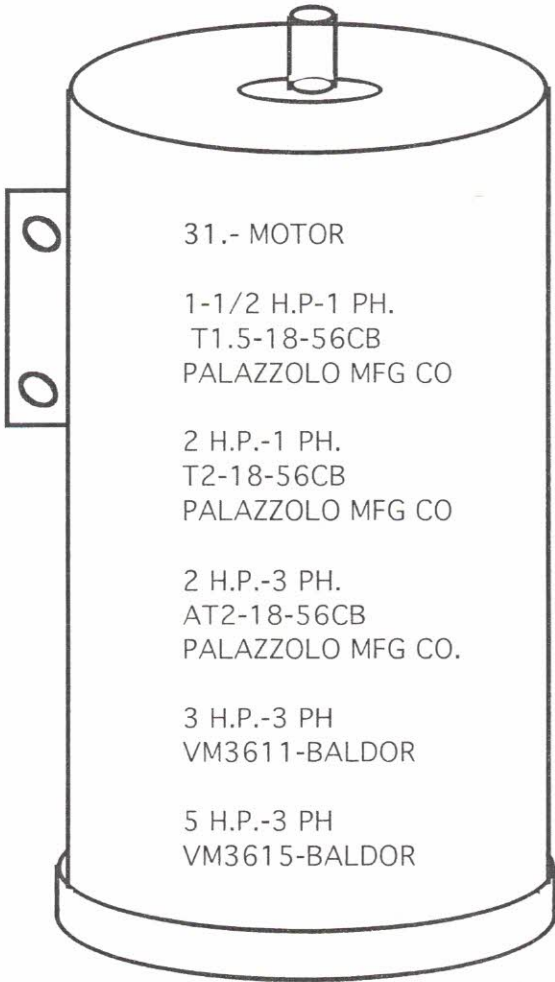

31.- MOTOR

1-1/2 H.P.-1 PH.
T1.5-18-56CB
PALAZZOLO MFG CO

2 H.P.-1 PH.
T2-18-56CB
PALAZZOLO MFG CO

2 H.P.-3 PH.
AT2-18-56CB
PALAZZOLO MFG CO.

3 H.P.-3 PH
VM3611-BALDOR

5 H.P.-3 PH
VM3615-BALDOR

INTERLOCK SWITCH
CARLING SWITCH
172 SERIES - PART #

ON-OFF SWITCH
W.W. GRAINGER
1XC15- PART #



30.- CONTACTOR SWITCH
W.W. GRAINGER
5B118 - 120 V COIL
5B117 - 208/240 V COIL



27.- JACK SHAFT
PALAZZOLO MFG CO.

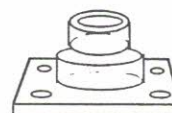

29.- 3/4" BEARING
W.W. GRAINGER
1F548 PART#

REPLACING THE BELT

1. REMOVE THE FRONT END PARTS FROM THE MOTOR HOUSING.
2. WITH AN ALLEN WRENCH, LOOSEN THE SET SCREW ON THE SIDE OF THE HUB AND CAREFULLY PRY UP ON THE HUB TO REMOVE IT FROM THE DRIVE SHAFT.
3. WITH A PAIR OF PLYERS, LOOSEN AND REMOVE THE 2 CARRIAGE BOLTS LOCATED ON THE LEFT AND RIGHT SIDES NEAR THE FRONT OF THE MOTOR HOUSING . WITH A PHILLIPS HEAD SCREW DRIVER, REMOVE ONLY THE TOP SCREW ON THE LEFT AND RIGHT OF THE REAR PANEL. LIFT UP ON THE TOP OF THE MOTOR HOUSING AND REMOVE IT FROM THE BASE.
4. REFER TO THE SKETCH BELOW. TURN THE PULLEY UNTIL THE 2 ALLEN SCREWS ARE IN THE SAME POSITION WITH THE FRONT OF THE MACHINE AS SHOWN IN THE SKETCH. LOOSEN AND REMOVE THE 2 ALLEN SCREWS FROM THE BUSHING AT IN THE CENTER OF THE PULLEY.
5. PLACE ONE OF THE ALLEN SCREWS INTO THE REMOVAL HOLE AND SCREW IT INTO THE HOLE. AS YOU SCREW THE ALLEN SCREW IN, THE BUSHING WILL RISE UP OUT OF THE PULLEY. ONCE THE BOTTOM SURFACE OF THE BUSHING CLEARS THE TOP SURFACE OF THE PULLEY, PUSH THE PULLEY TOWARDS THE REAR OF THE MACHINE.
6. AT THIS POINT, YOU CAN REMOVE THE OLD BELT AND INSTALL THE NEW BELT . WITH THE NEW BELT INSTALLED, PUSH THE PULLEY TOWARDS THE FRONT OF THE MACHINE. MAKING SURE THE 2 HOLES IN THE BUSHING AND THE PULLEY ARE LINED UP. PUSH THE BUSHING DOWN INTO THE PULLEY AS FAR AS YOU CAN. INSTALL THE 2 ALLEN SCREWS INTO THE ORIGINAL 2 HOLES AND ALTERNATELY TIGHTEN THEM. THIS WILL DRAW THE BUSHING DEEPER INTO THE PULLEY AND STRETCH THE BELT TIGHT. WHEN THE TOP OF THE BUSHING IS ALMOST EVEN WITH THE TOP SURFACE OF THE PULLEY, CAREFULLY TAP THE BUSHING DOWNWARD AS FAR AS IT WILL GO.
7. TIGHTEN THE TWO ALLEN SCREWS AS TIGHT AS YOU CAN. REPLACE THE TOP ONTO THE MACHINE HOUSING AND INSTALL AND TIGHTEN THE 4 SCREWS.
8. REPLACE THE HUB ONTO THE SHAFT MAKING SURE YOU LINE UP THE KEY WAY SLOTS OF THE HUB AND SHAFT. INSTALL THE KEY INTO THE SLOT UNTIL IT IS FLUSH WITH THE TOP OF THE HUB. TIGHTEN THE SET SCREW.

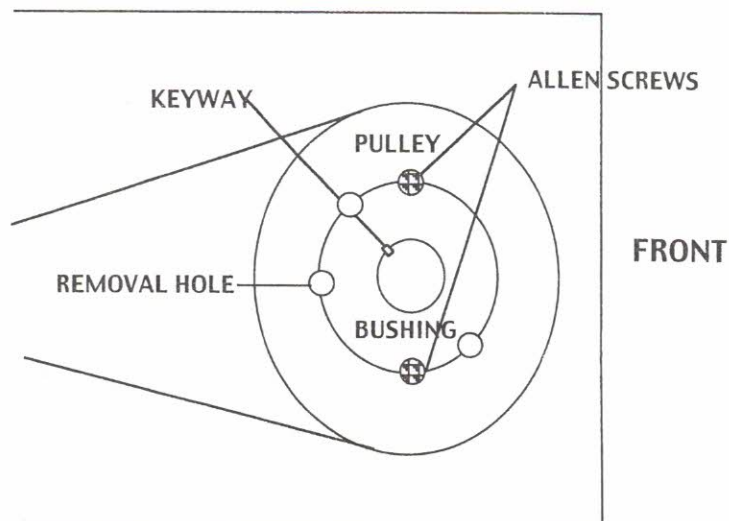

2 H.P.- 3 H.P. & 5 H.P. THREE PHASE WIRING DIAGRAM

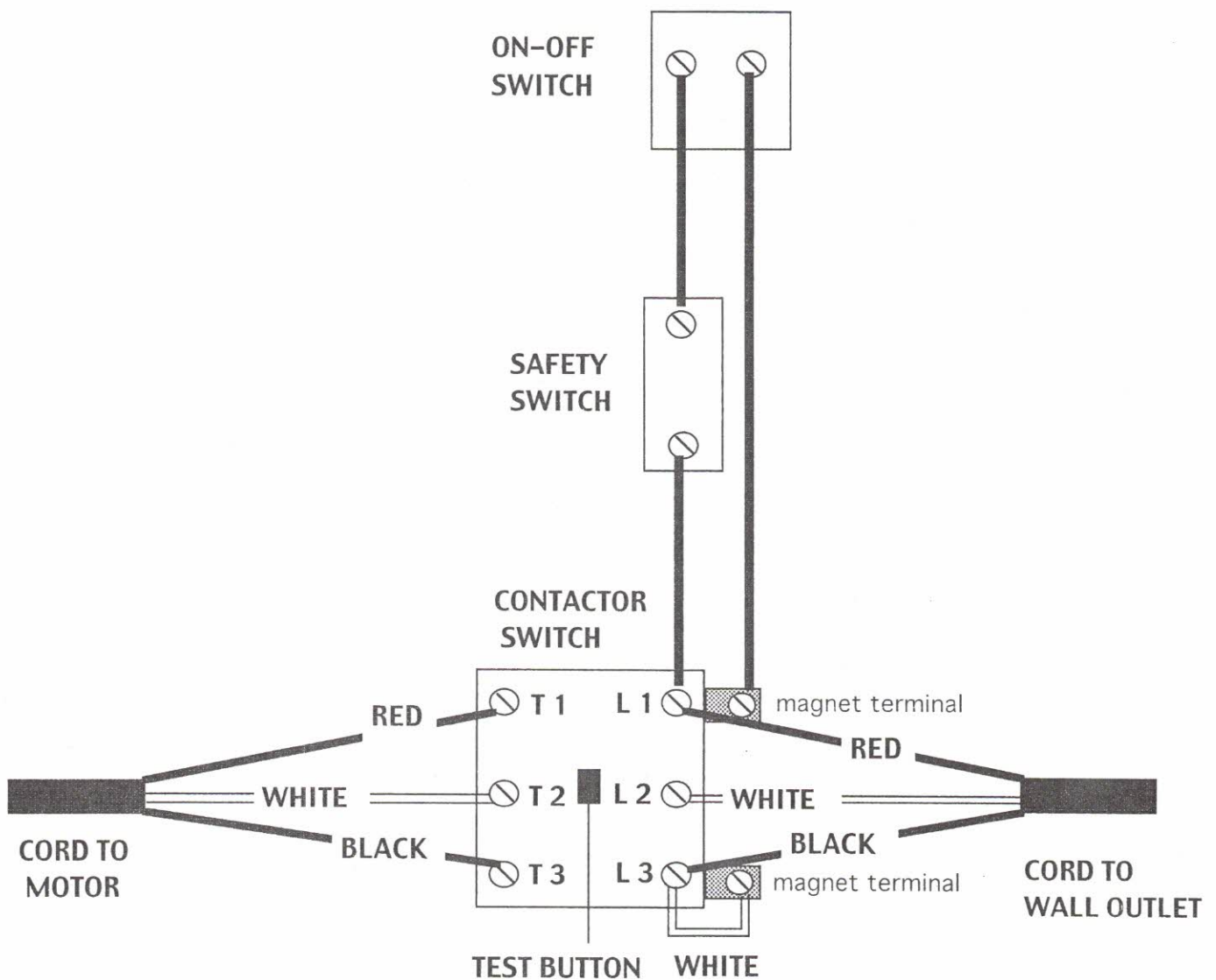

1-1/2 H.P. & 2 H.P. SINGLE PHASE WIRING DIAGRAM

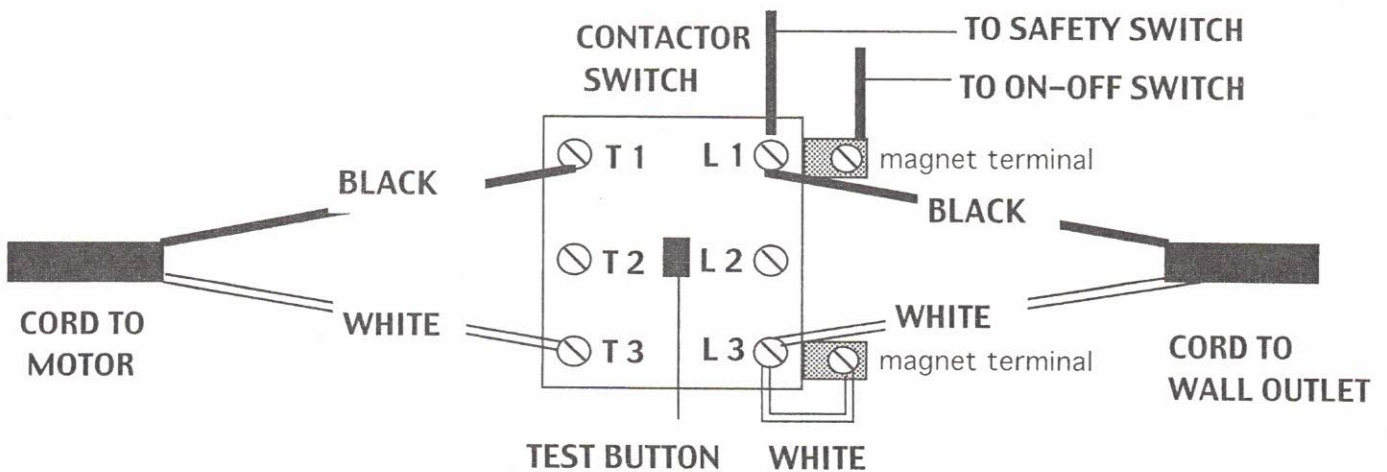

TROUBLE-SHOOTING THE ELECTRICAL SYSTEM ON YOUR MACHINE

THE ELECTRICAL CIRCUIT IN YOUR MACHINE IS VERY SIMPLE. THERE ARE 2 BASIC CIRCUIT LOOPS, THE ON-OFF SWITCH AND THE INTERLOCK SWITCH CONNECTED TO THE MAGNET IN THE CONTACTOR SWITCH IS ONE CIRCUIT AND THE CORD FROM THE WALL OUTLET, THE CONTACTOR SWITCH TERMINALS, AND THE CORD TO THE MOTOR IS THE SECOND CIRCUIT. (REFER TO WIRE DIAGRAMS ON PREVIOUS PAGE 15.)

1. IF YOUR MACHINE DOES NOT START WHEN YOU TURN IT ON, CHECK THE CIRCUIT BREAKER IN YOUR ELECTRICAL PANEL BY TURNING IT OFF AND THEN BACK ON. WITH A VOLTAGE METER, CHECK THE WALL OUTLET TO MAKE SURE THE OUTLET IS HOT AND IT IS PUTTING OUT THE CORRECT VOLTAGE. IF THE MACHINE STILL DOES NOT START, OPEN THE PLUG ON THE CORD GOING FROM YOUR MACHINE TO THE WALL OUTLET TO MAKE SURE NO WIRES CAME LOOSE. THIS CAN ONLY BE PERFORMED IF YOUR MACHINE HAS A 3 PHASE MOTOR. CLOSE THE PLUG AND TEST THE MACHINE AGAIN. IF THE MOTOR DOES NOT START, CONTINUE TO STEP 2.
2. REMOVE THE FRONT COVER FROM THE MACHINE CASE. PUSH THE BLACK TEST BUTTON ON THE CONTACTOR SWITCH IN. IF THE MOTOR STARTS, GO TO STEP 3. IF THE MOTOR DOESN'T START, THE MOTOR OR THE ELECTRICAL CIRCUIT TO YOUR MACHINE IS FAULTY. HAVE AN ELECTRICIAN CHECK YOUR ELECTRICAL CIRCUIT. IF THE ELECTRICAL CIRCUIT TESTS OKAY, YOU HAVE A MOTOR PROBLEM. CALL US AT 1-800-513-6333 FOR THE NEAREST BALDOR ELECTRIC COMPANY SERVICE CENTER.
3. IF YOU DO NOT HEAR THE CONTACTOR SWITCH CLICK WHEN YOU TURN YOUR ON-OFF SWITCH TO THE ON POSITION, THAT SUGGESTS THAT THE ON-OFF SWITCH, THE INTERLOCK SWITCH, AND THE CONTACTOR MAGNET CIRCUIT IS NOT WORKING. **UNPLUG THE MACHINE** FROM THE WALL OUTLET. USE A CONTINUITY TESTER ON THE INTERLOCK SWITCH AND THE ON-OFF SWITCH TO MAKE SURE THEY ARE TURNING ON AND OFF WHEN YOU OPERATE THE SWITCHES. IF THESE 2 SWITCHES TEST OKAY, THEN THE CONTACTOR SWITCH IS THE PROBLEM AND NEEDS TO BE REPLACED.

CALL US AT 1-800-513-6333 IF YOU HAVE ANY QUESTIONS.